

# STI Euro Stopper

## Installation Data for the STI-15000 Series

The Euro Stopper is a sleek protective cover that offers protection against tampering, vandalism and damage from accidental activation

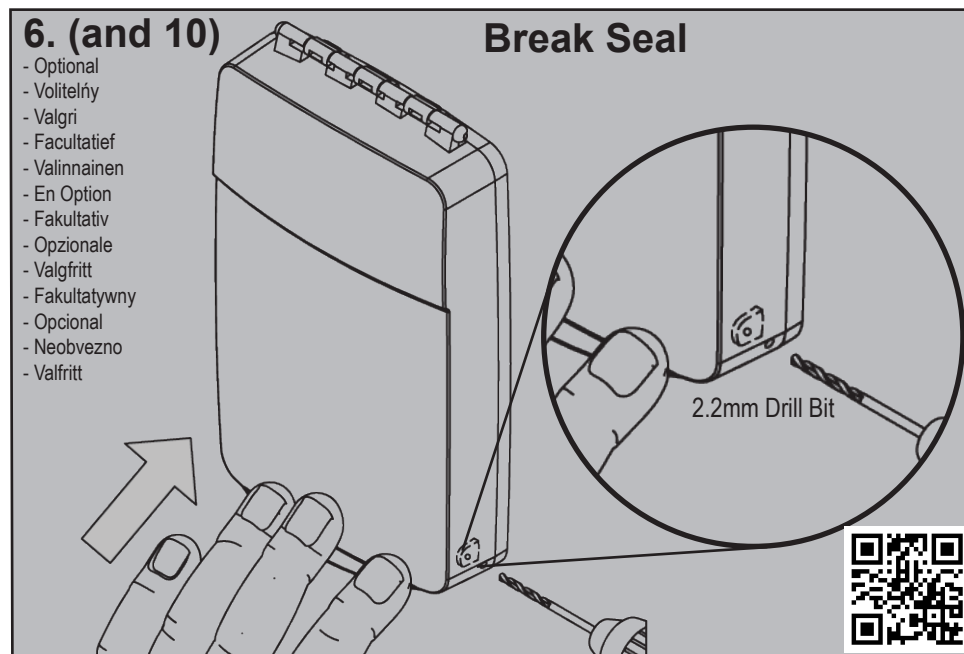
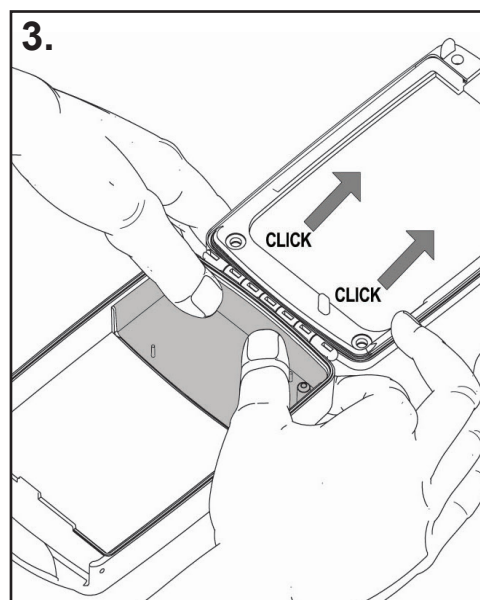
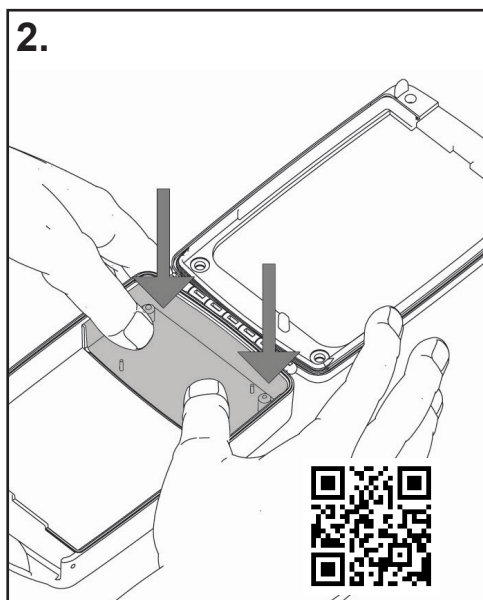
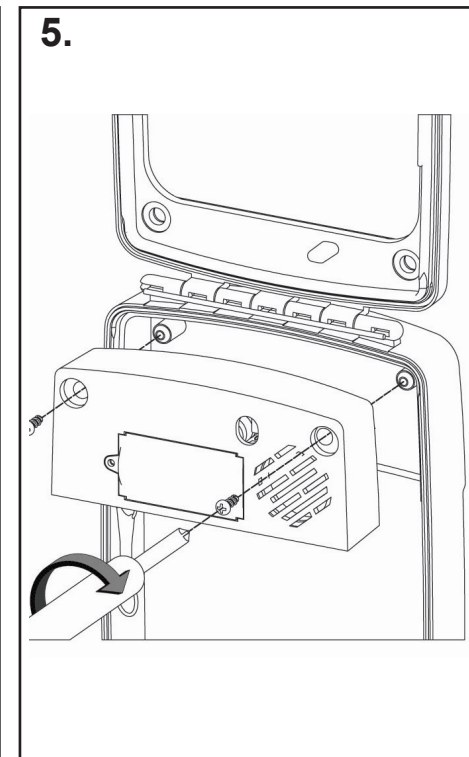
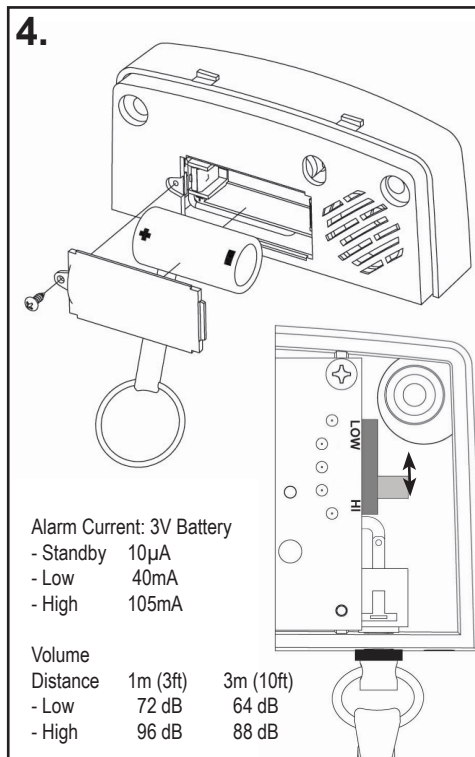

Need help? Call our Technical Support Team on 800-888-4784

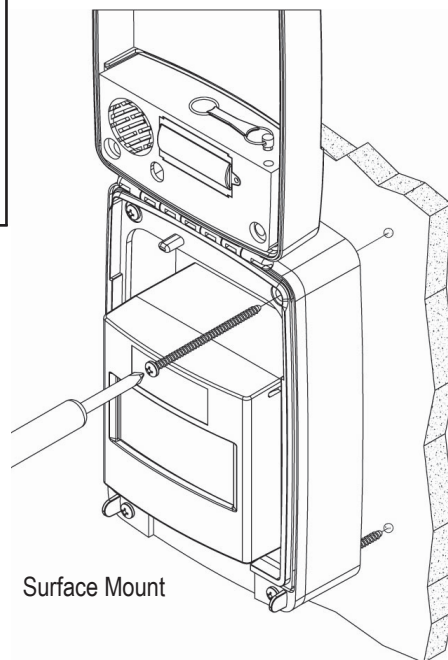
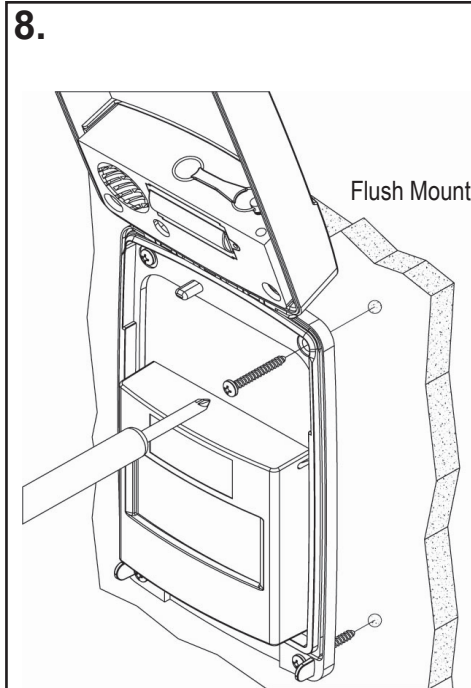
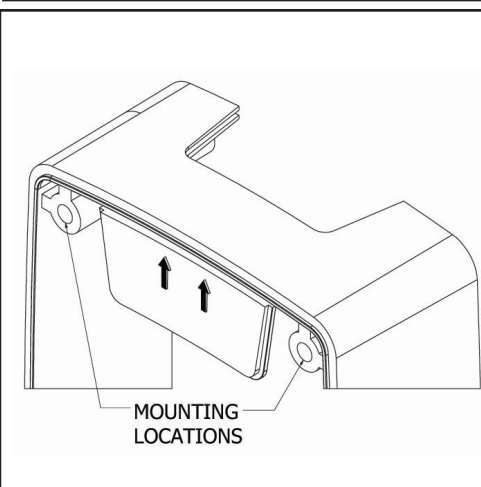
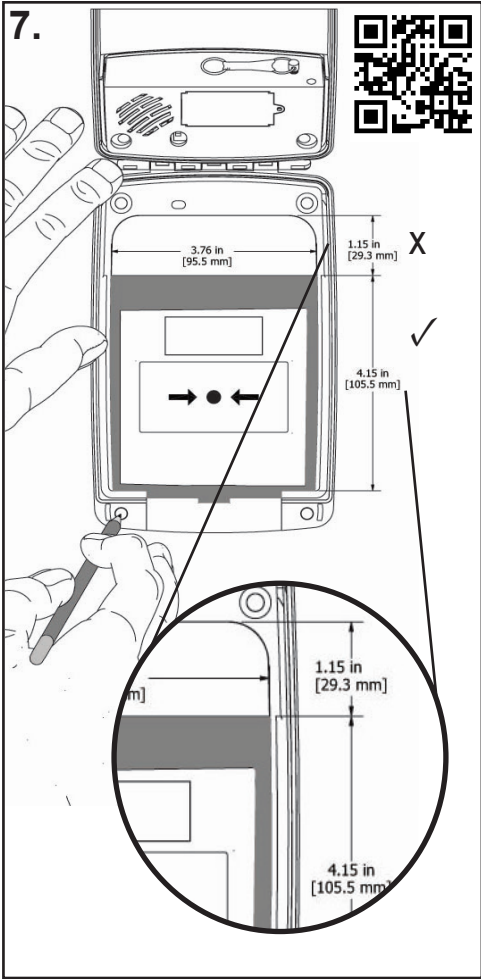

Need help? Call our Technical Support Team on 800-888-4784

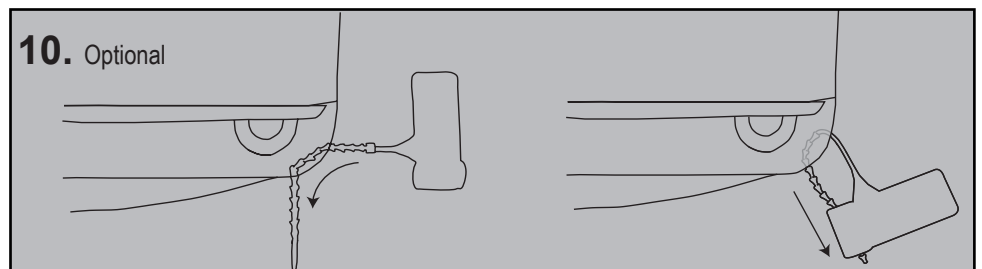
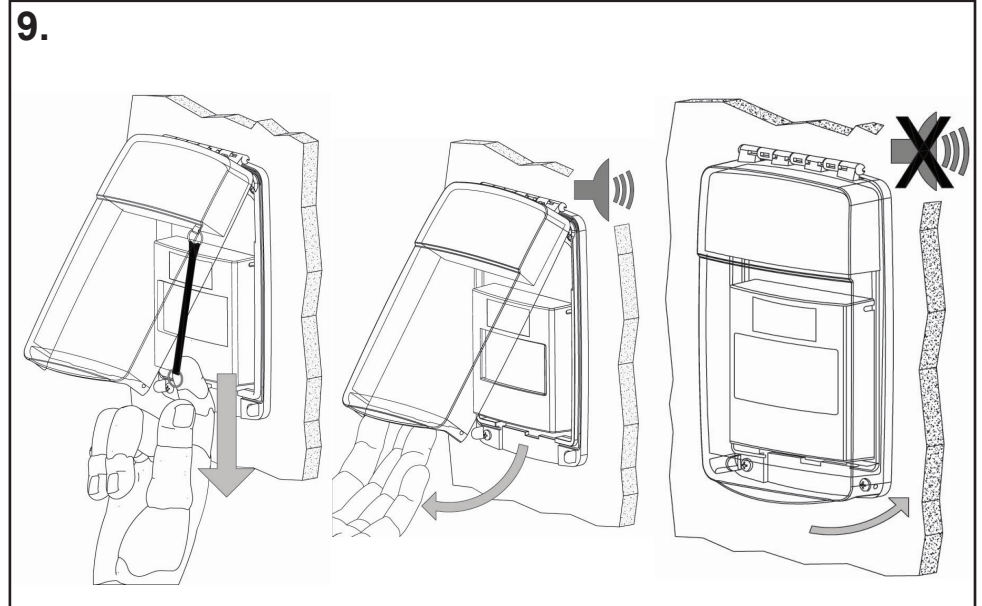

Euro Stopper  
Multi Kit  
**FLUSH MOUNT**  
Installation Video



Euro Stopper  
Multi Kit  
**SURFACE MOUNT**  
Installation Video

⚠ WARNING : This product can expose you to chemicals including Dichloromethane, which is known to the State of California to cause cancer, and Bisphenol A (BPA), which is known to the State of California to cause birth defects or other reproductive harm. For more information go to [www.P65Warnings.ca.gov](http://www.P65Warnings.ca.gov)



**Safety Technology International**

**European Office**

Taylor House, 34 Sherwood Road, Bromsgrove  
Worcestershire, B60 3DR, UK  
Tel: 01527 520 999 Fax: 01527 501 999  
[info@sti-emea.com](mailto:info@sti-emea.com) [www.sti-emea.com](http://www.sti-emea.com)

**USA - Headquarters**

2306 Airport Road, Waterford,  
Michigan 48327, USA  
Tel: 248-673-9898 Fax: 248-673-1246  
[info@sti-usa.com](mailto:info@sti-usa.com) [www.sti-usa.com](http://www.sti-usa.com)