

MOUNT  
NPT STANDARD  
EQUIPMENT TO  
POLES

# BT5951

## NPT ADAPTOR FOR Ø38MM POLES

The BT5951 is an NPT pole adaptor from B-Tech's System V Range; a collection of components designed for the installation of CCTV and other ceiling mounted equipment. Designed to fix equipment using an NPT standard 1.5" thread to the bottom of B-Tech BT5935 ø38mm poles, users of System V can create custom ceiling mounted solutions that suit their specific needs, using compatible accessory collars to mount additional AV equipment such as flat screens if required.

### SPECIFICATION

External dimensions	107mm x 55.8mm
Colour	White

### FEATURES

- Attach NPT (1.5") compatible equipment to System V ø38mm poles
- Multiple grub screws allow micro-adjustment of the pole to ensure a perfectly angled drop
- Allows cables to pass through the poles and adaptor
- Safety bolt hole ensures a secure connection to System V poles
- Create a variety of ceiling mounted CCTV installs using System V's range of components



Multiple grub screws allow micro-adjustment of the pole



Attach a security camera with NPT standard 1.5" thread to a System V pole



Safety bolt hole ensures a secure connection to System V poles



Heavy duty steel capable of supporting substantial loads

TOP VIEW

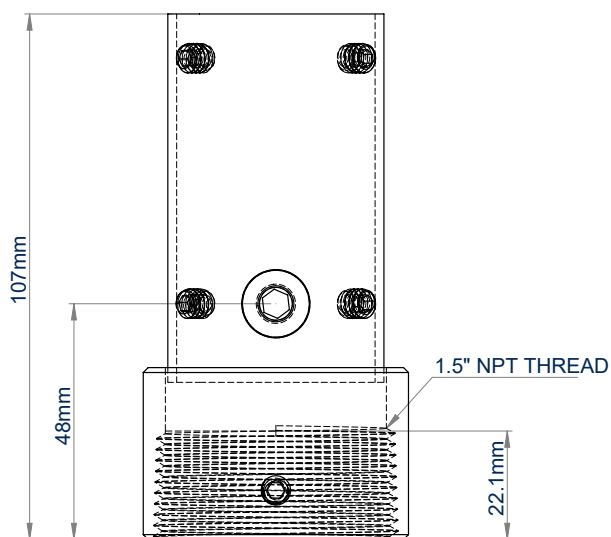
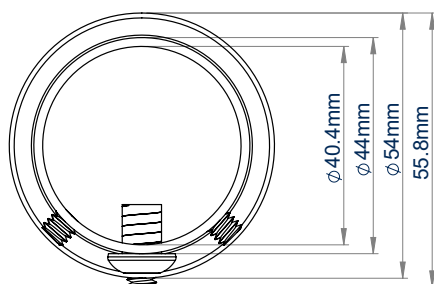

FRONT VIEW

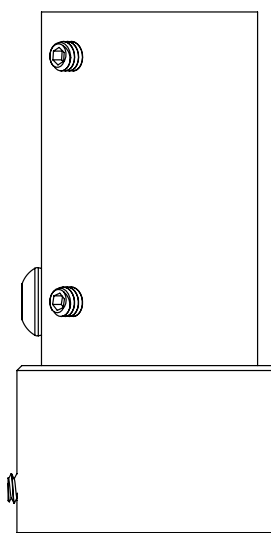

SIDE VIEW

## PACKING INFORMATION

COLOUR:	ORDER REF:	EAN CODE:	CARTON QTY:	INNER CARTON QTY:	MASTER CARTON WEIGHT:	MASTER CARTON CUBE:
White	BT5951/W	5019318304385	30	N/A	11.35kg	0.01cbm

## RELATED PRODUCTS

BT5935

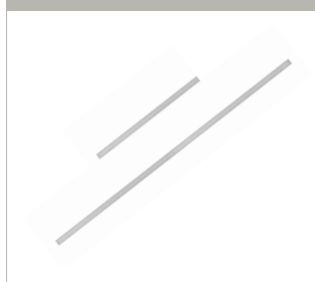

**38mm diameter poles**  
Available in 1 metre or 2 metre lengths

BT5920



**Fixed Ceiling Mount**  
Mounts BT5935 ø38mm poles to the ceiling

BT5910



**Dome Security Camera Mount**  
Carousel mount for small / medium dome CCTV cameras

BT5924



### External Pole Joiner for ø38mm Poles