

METAL SOUND PROJECTORS



➤ **CELL20/T**

➤ **CELL20/TC**

TECHNICAL SPECIFICATIONS

Rated power, Watts	20
Tappings 100 volt line, Watts	20/10/5/2.5
Transformer Impedance, Ohms, 100V	500/1k/2k/4k
Tappings 70.7 volt line, Watts	10/5/2.5/1.25
Driver impedance, Ohms	8
Effective frequency range, Hz (BSEN60268-5)	110-16,000
S.P.L. @ 1m, 1 watt, dB, Test Signal Bandwidth 100Hz – 10 kHz	88
S.P.L. @ Full power, Octave Bandwidth, dB	101
Acoustic Power (dB-PWL@1 Watt) 1k/2k Hz, dB	87/84
Dispersion at 1k/2k Hz, Degrees	180/120
Directivity Axial Q factor, 1k/2kHz	2.6/5.9
Dimensions, front & depth, mm	Ø140 x 191
Net weight, Kgs	2.3
Colour/Finish	White RAL9016
Material	Aluminium with Stainless steel hardware
Mounting	Aluminium U bracket

➤ CELL20/TC is BS5839 Part 8 Voice Alarm compliant

➤ **CELL20/T**

➤ **CELL20/TC**

METAL SOUND PROJECTORS

▼ side view
unit: mm

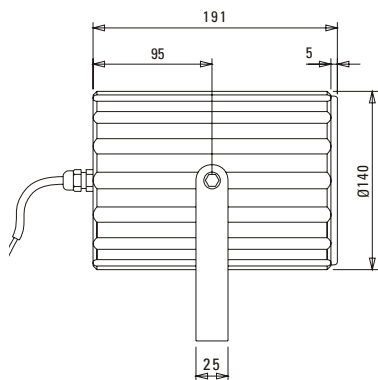

▼ front view
unit: mm

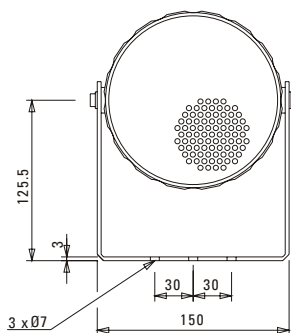

▼ circuit diagram
CELL20/T

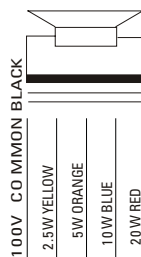

speech octave band sensitivity

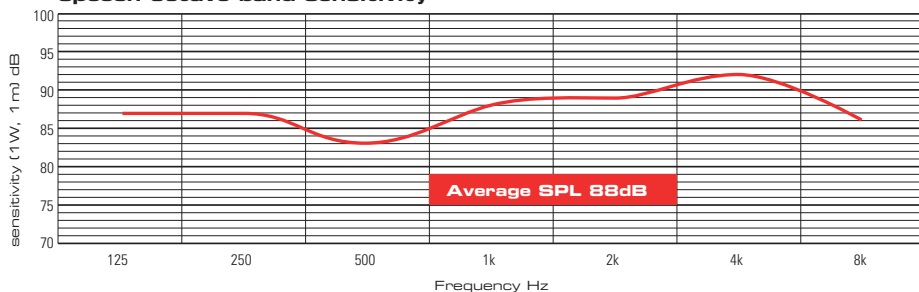

Effective Frequency Range ● **CELL20/T CELL20/TC** 110Hz - 16,000Hz



Penton UK Ltd

Unit 2 Teville Industrials | Dominion Way | Worthing | West Sussex | BN14 8NW

T: +44 (0)1903 215315 | F: +44(0)1903 215415 | E: SALES@PENTONUK.CO.UK

www.pentonuk.co.uk