



**KNIGHT**  
FIRE & SECURITY

## Magnetic Contact Switches

### Specification: AR Series

- \*19mm Diameter press to fit
- \*Suitable for steel door install
- \*Self locking
- \*Standard 500mm #22AWG Leads
- \*Switch or Magnet are available separately
- \*Specials leads available on request
- \*Resistor, Diode and Supervisory Loop available on request
- \*Colours: White, Brown

### Recessed mounted



CE

### Dimensions (mm)

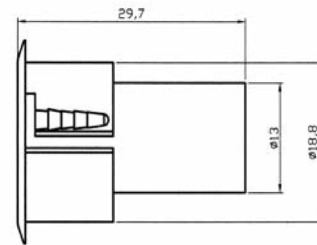
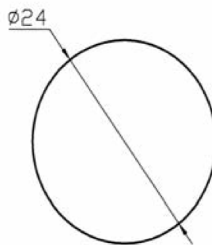
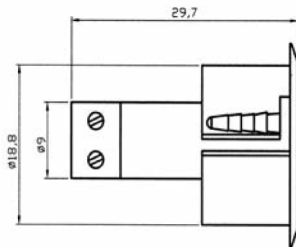

### Alternate Magnets:

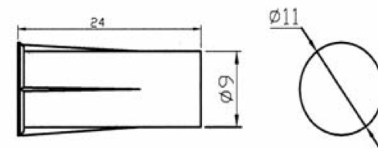

M2 for AR02



### Order Information – Product supplied in WHITE by default. Add 'B' to part code to order in BROWN (E.G. AR01B)

Part Number	Loop Type	Reed Form	Closed Gap in steel door (mm)	Departure Gap in steel door (mm)	Max Initial Contact Resistance (Ohm)	Max Initial Contact rating (W)	Max Switching Voltage (VDC/VAC)	Max Switching Current (A)
AR01	Closed	N/O	15	17	0.150	7.5	100	0.4
AR02	Closed	N/O	23 in wood	24	0.150	7.5	100	0.4

Note: 1 Gap will increase substantially for installations other than steel  
2 Wire range for terminals: #20 ~#24AWG



### KNIGHT FIRE AND SECURITY PRODUCTS LTD

UNIT 84 SEAWALL ROAD INDUSTRIAL ESTATE, CARDIFF, CF24 5TH

T: +44 (0) 2920 488129 | F: +44 (0) 2920 489132

W: [www.knightfireandsecurity.com](http://www.knightfireandsecurity.com) | E: [sales@knightfireandsecurity.com](mailto:sales@knightfireandsecurity.com)