

Features

- Meets the requirements of BS EN179 for escape levers
- Handle dimensions meet the requirements of the Disability Discrimination Act (1995) and Equality Act (2010)
- 'Return to door' design ideal for fire escape doors
- Fixing plates are made of stainless steel with 2 pairs of holes placed to suit DIN or Scandinavian standards
- Stainless steel tube, 1.25mm thick, to prevent overload of the lockcase, with no need for a support spring
- Supplied complete with relevant escutcheons, roses/plates and fixings

▼ 60-0219-PSS 60-0319-SSS 60-0519-PSS 60-0619-PSS

Lever on round rose

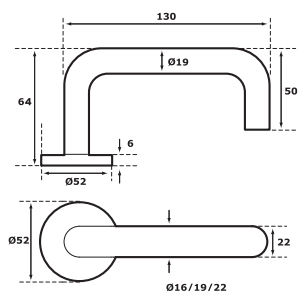

▼ 60-0119-SSS

Lever on longplate

- Knobs on outside of door

▼ 60-0419-SSS

Lever on longplate

- Pair of handles

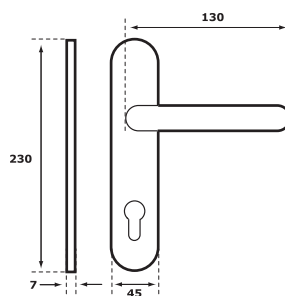

▼ 60-0719-SSS 60-0819-SSS

Fixed pad and lever on narrow longplate

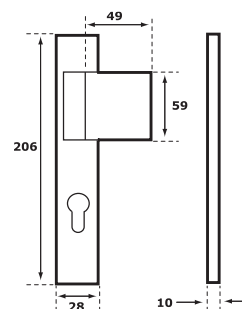

COMPATIBILITY HANDLE	EL520	EL590	EL560	EL561	EL580	EL582	EL420	EL460	EL461
60-0119-SSS	•								
60-0219-PSS		•							
60-0319-SSS			•	•					
60-0419-SSS			•	•					
60-0619-PSS					•	•			
60-0719-SSS							•		
60-0819-SSS								•	•

PSS: Polished stainless steel SSS: Satin stainless steel