



signo

Mod.
1740

DS 1740-002A

LBT 8252

- Prepare the conduit so that it terminates at the infeed hole provided.
- Use the 4 screws to fasten the bracket to the wall at the height from the floor indicated.
- Connect the conductors to the special terminals.
- Pull the fastening hook α downwards.
- Insert the video door phone in the bracket.
- Fasten the video door phone in place pushing hook α upwards.

Button	Terminals	
	Z1; Z2	0,5A 18Vdc
	Y1; Y2	
	X1; X2	

INSTRUCTIONS FOR FIXING THE BRACKET TO THE WALL

Sch./Ref. 1740-90

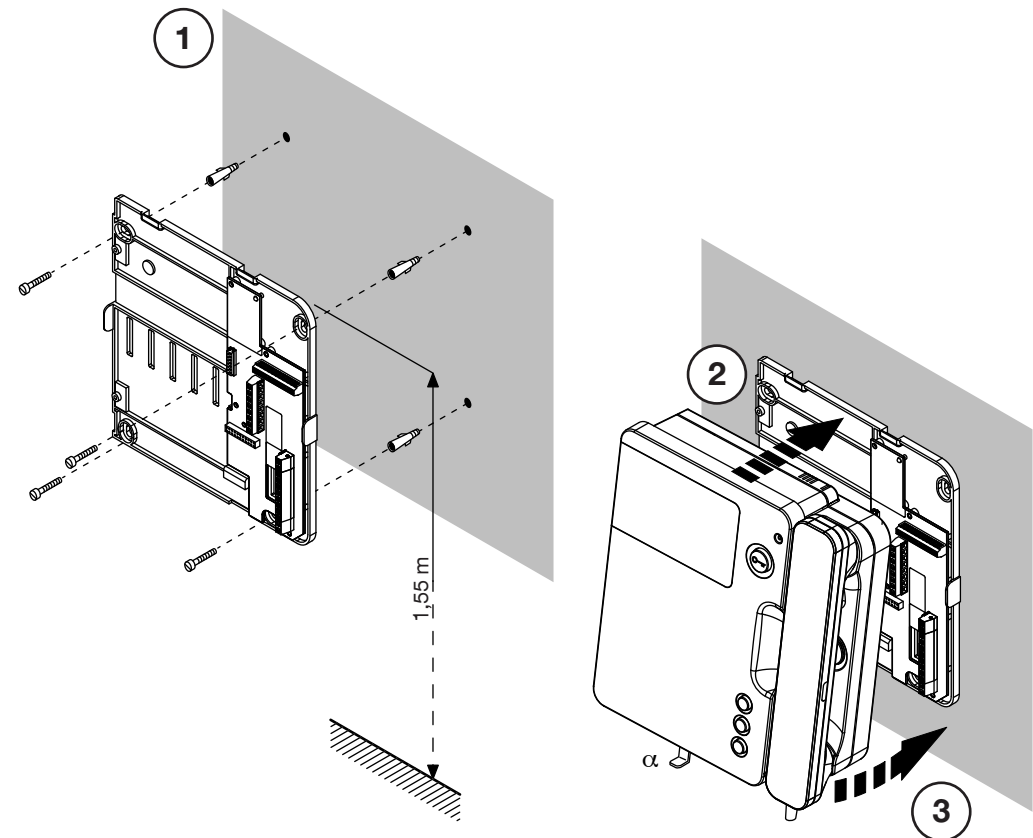

URMET DOMUS COMMUNICATION AND SECURITY UK LTD

Urban Hive, Skyline 120, Avenue West, Great Notley, Essex CM77 7AA

Telephone: 01376 556010 Fax: 01376 567874 email: sales@urmet.co.uk web: www.urmet.co.uk

urmet
IS IN YOUR LIFE

