

Securefaßt

Electronic Locking & Access Control Systems

securefast.co.uk

SPECIFICATION MANUAL



Part of the

Securefaßt Group

2.

www.securefast.co.uk

PUTTING **YOU** IN CONTROL

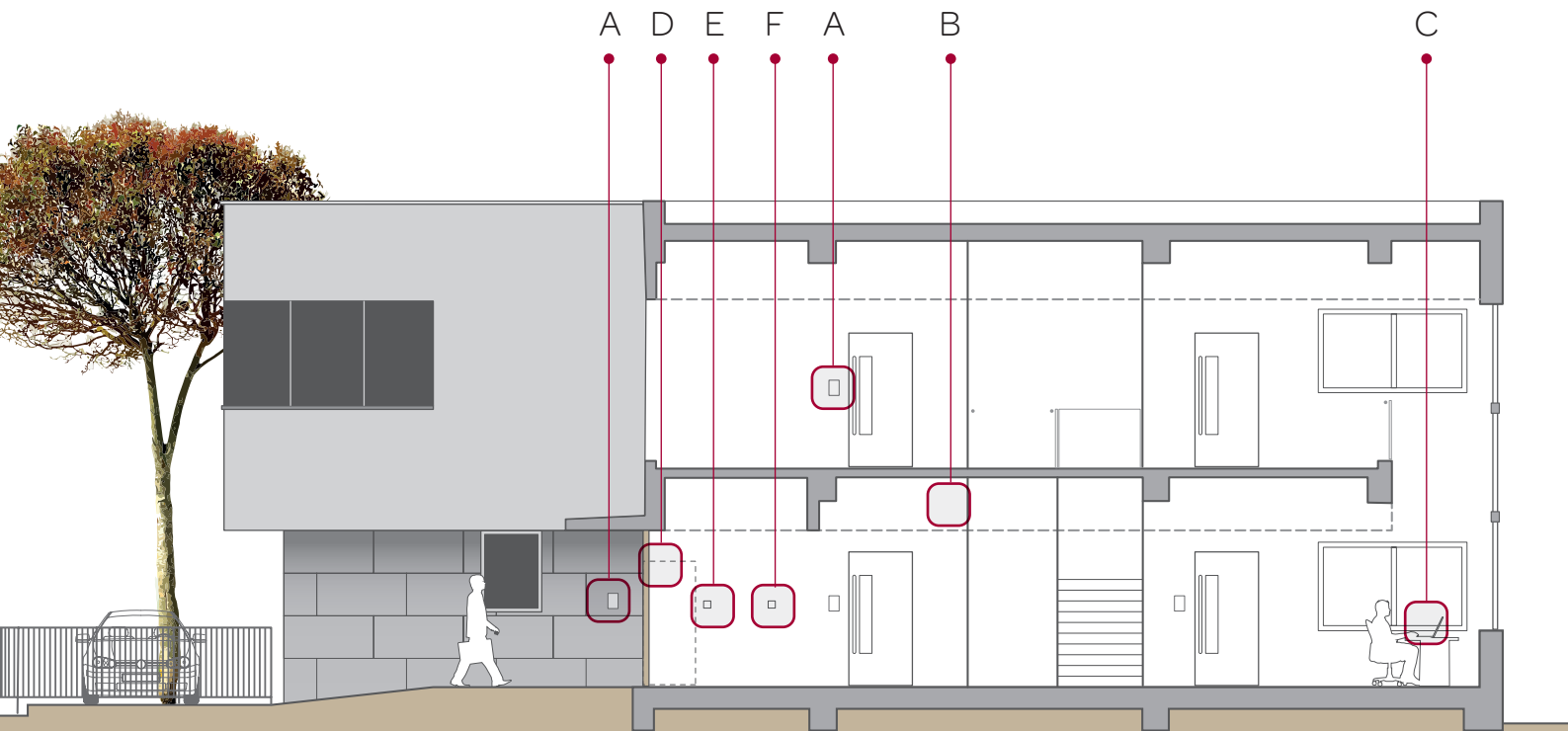

ACCESS CONTROL

TEL: +44 (0) 1704 502801

UNDERSTANDING ELECTRONIC ACCESS CONTROL

Electronic access control has become commonplace in hotels, hospitals, schools and large commercial premises. Whilst advances in battery and wireless technologies have led to more economic solutions for internal or external doors, there are a large number of projects which have gates or barriers that require an electronic form of locking which calls for a hardwired solution.

With Securefast systems you can mix both hardwired and wireless systems.

The hardwired access control system is flexible and convenient, with the user being able to control anything from a single door to a large scale organisation of multiple doors in a single building or multiple buildings such as a university campus. Unlike a conventional keyed system, the electronic solution gives you the reassurance of knowing who is moving in and around your building at any time with the ability to cancel a user or door access within seconds.

With Entra+ access control you can:

- Eliminate concerns over lost or stolen keys
- Control who is allowed access where and when
- Change access rights for individual users or doors in real time
- Automate locking and unlocking of specific doors
- Delete or add personnel instantly from or into the system
- Monitor door activity and react to security incidents
- Control your building's security from anywhere in the world
- Control not only personnel doors but lifts, car park barriers, gates and automatic doors
- Integrate other building services such as alarms, CCTV or building management systems
- Lift integration with KONE or OTIS lift systems
- Live roll call in case of emergency

THE MAIN ELEMENTS OF A SYSTEM

A hardwired access control system will require the following elements:

PAGE 6 - 11

A

READING TECHNOLOGY - Wall mounted readers providing access by Token, Card and/or PIN or Biometrics. Readers are available for internal and external applications. Card or token types include: EM, MiFARE, DesFIRE

PAGE 12

B

CONTROLLER - Provides the interface between the reader, the lock and the management software. Usually combined with a boxed power supply, the unit is usually concealed within a ceiling void, convenient cupboard or service duct. Up to 4 controllers may be installed into one power supply

PAGE 13

C

SOFTWARE - PC software used to organise, programme and monitor your system. It provides your day to day control over who goes where and when. Terminus software will control both online and wired locking systems.

PAGE 20 - 46

D

ELECTRIC LOCKING - Physical locking of doors, gates and barriers can be selected from a range of options such as electromagnets, door releases and electric locks to suit particular requirements. Power is taken from the boxed power supply [B]

PAGE 47 - 50

E

REQUEST TO EXIT - In most cases easy and immediate exit is required and this can be achieved through a range of touch button, push buttons, pads or sensors

PAGE 51 - 53

F

LIFE SAFETY - Depending on the design of the door or the type of application a number of additional components may be required such as emergency break glass to over ride the system in case of emergency

INTRODUCTION

The **Entra+** system offers versatile management of access control from a single door up to a multi-site network.

The heart of the **Entra+** system is a sophisticated yet compact controller which can be used with a wide range of readers and reading technologies including Mifare, DesFire and RFID proximity in addition to biometrics and keypads, all on the same network. This allows the most appropriate readers to be sited at each door type. For example, long range proximity at the car park, close range proximity with PIN for the main entrance and reader only for strategic internal doors.

The **Smart Entra** system offers you the convenience of both **wired** and **wireless** locks on the same network. For all high user doors **Entra+** wired readers offer the convenience of wide selection of readers. Where there are doors which, for a number of reasons, are not able to be connected to the wired network, the **Smart Entra 'OnDoor System'** allows total flexibility.



Incorporate multiple reading technologies
on the same system

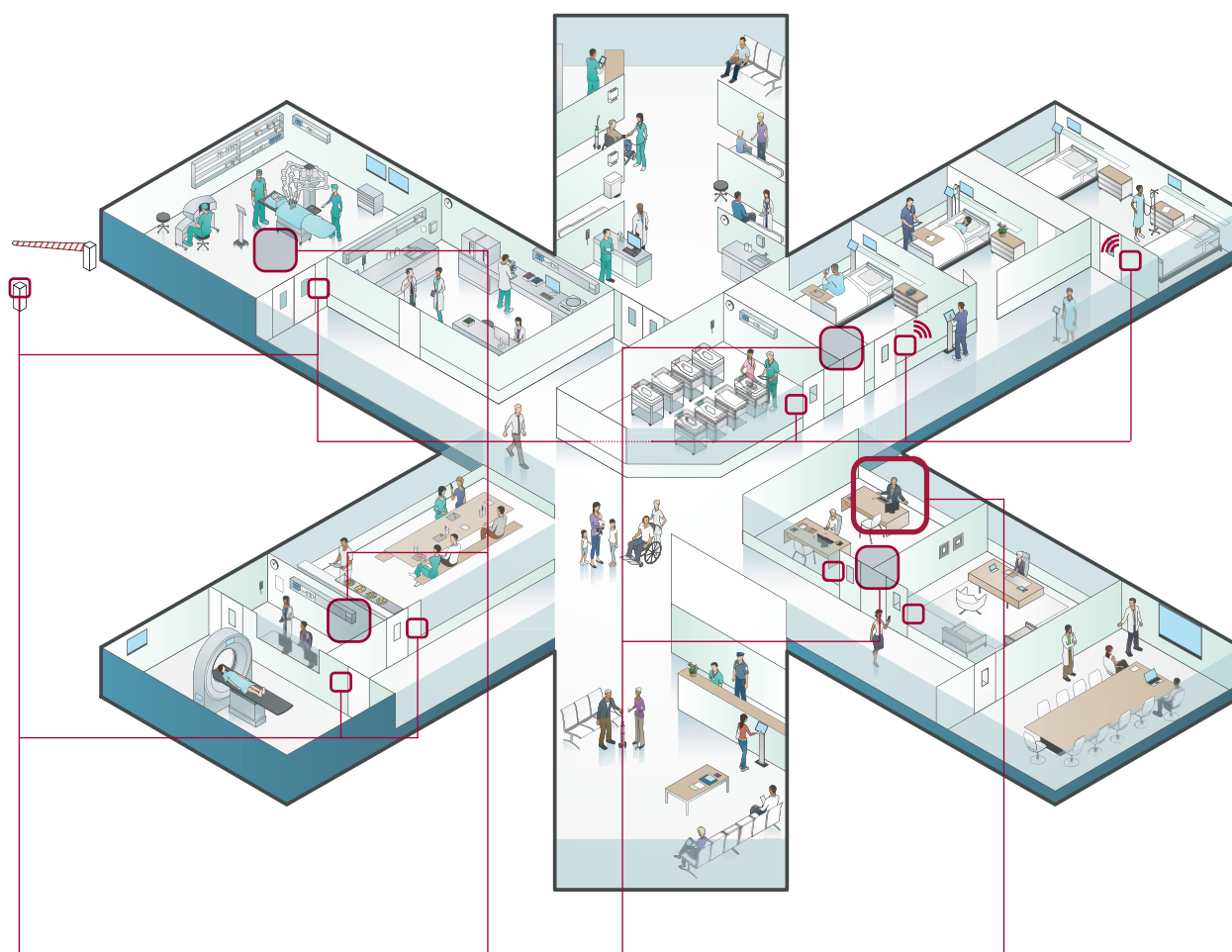

READERS

The **Entra+** system includes a wide range of reader types and technologies, allowing you to closely match the reader type to the application. For example, you can specify dual credential readers for external and critical internal doors.

CONTROLLERS

Available as a single module or contained within a 12v power supply unit the **Entra+** controllers can be supplied in the PSU to control single or a multiple number of doors in close proximity.

Controllers within a PSU is normally concealed in a secure area or in ceiling voids throughout the building and linked to the management system via a network.

SOFTWARE

The **Entra+** system uses Terminus, a powerful software package which provides an exceptionally user friendly tool to control the access control network from a central computer. The system has no limitations in the number of doors and users with the option to link a number of sites to one management system.

Reader options



CIDRON READERS

The Cidron readers are supplied with two options; reader only or reader with keypad.

Based on the high security **DesFIRE** platform the readers read a unique code encoded into a sector of card's key. The user or their staff can only procure the cards from the registered supplier in the same way as a high security master keyed system.

For less secure projects the readers may be supplied to simply read the card's UID code.

High visibility proximity reader suitable for internal or external applications.

High visibility keypad suitable for internal or external applications.

Both readers are available in black or white.



Product code:	AEN1070	AEN1080
Frequency	13.56Mhz	13.56Mhz
Card read range	45mm	45mm
Fob read range	25mm	25mm
User Limit	No limit	No limit
Power/current	12V DC / 35mA with 92mA draw	
Dimensions (w/h/d)	45 x 140 x 30	45 x 140 x 30

Reader options

MIFARE READERS

AEN82MF

A range of slimline readers with proximity or proximity and keypad. The units have a backlit touch keypad and are available in a high gloss black or white.



Product code:	AEN82MF	AEN82MF-BK
Type	Proximity & Keypad	Proximity only
Frequency	13.56Mhz	13.56Mhz
Card read range	60mm	60mm
Fob read range	25mm	25mm
User Limits	Up to 120	Up to 120
Power	10 - 15 vdc	10 - 15 vdc
Dimensions (w/h/d)	85 x 85 x 22	85 x 85 x 22
Datasheet	DS14-003	DS14-003

MIFARE READERS

AEN84MF

A narrow style version of the AEN82MF readers. Both types of reader have a high gloss architectural finish and are suitable for all internal applications where a sophisticated high quality look is required.



Product code:	AEN84MF	AEN84MF-BK
Type	Proximity & Keypad	Proximity only
Frequency	13.56Mhz	13.56Mhz
Card read range	60mm	60mm
Fob read range	25mm	25mm
User Limits	Up to 120	Up to 120
Power	10 - 15 vdc	10 - 15 vdc
Dimensions (w/h/d)	45 x 130 x 22	45 x 130 x 22
Datasheet	DS14-004	DS14-004

MIFARE READERS**AEN1010**

Slimline reader suitable for internal or external applications.

AEN1020

Slimline reader suitable for internal applications offering proximity authentication.



Product code:	AEN1010	AEN1020
Frequency	13.56Mhz	13.56Mhz
Card read range	45mm	45mm
Fob read range	25mm	25mm
User Limits	No limits	No limits
Power	9 - 16V DC	9 - 16V DC
Dimensions (w/h/d)	58 x 120 x 20	50 x 110 x 18

ENTRA+ READERS**AEN1060**

Slimline INNOPROX II card reader suitable for harsh internal and external environments.

AEN1060PM

Panel mount reader can be fitted behind a standard door entry panel (below) or with a stainless steel face plate for mounting externally into a single gang back box.



Product code:	AEN1060	AEN1060PM
Frequency	125Khz	125Khz
Card/Fob read range	76mm	76mm
User Limits	No limits	No limits
Power	7 - 25V DC	7 - 25V DC
Dimensions (w/h/d)	50 x 110 x 18	60 x 60 x 18 Border faceplate



ONDOOR Smart Entra wireless readers are also available with cylinder override

SmartEntra integration

The **SmartEntra** system of 'On-Door' and 'In-Door' locks have now been integrated with Terminus PC software (see page 13), allowing it to work seamlessly alongside the **ENTRA+** on-line access control system.

SmartEntra doors can be fully configured and programmed from the Terminus software.

When enrolling a person, the Mifare card/fob can be simultaneously programmed for access on the **SmartEntra** and the **ENTRA+** doors according to the person's allocated access rights.

The **SmartEntra** wireless hubs report back to the Terminus software giving a live report of people using the SmartEntra doors. The software also keeps track of the **SmartEntra** lock's battery level, generating an alarm when it gets too low.

When a card/fob is invalidated in the Terminus software, it automatically stops working on the **SmartEntra** doors without requiring a programming card to be taken to the door.



Concealed 'In-Door' Smart Entra wireless readers allow you to select the door hardware you want.

ACCESS CONTROL



ASL951BW

ONDOOR SmartEntra wireless network



ASL95BASE

TYPICAL APPLICATIONS

ONDOOR SmartEntra wireless network systems are typically used in larger hotels, hostels, universities, hospitals and large commercial offices.

Access rights can be controlled in real time and the system enables remote door locking and unlocking, all controlled from the central PC software which also controls the **Entra+** hardwired network.

For full details see our ONDOOR access control manual.



ACCESS CONTROL

DESCRIPTION

The ASL951BW is part of the **SmartEntra** networked system which uses wireless base stations to communicate between the PC based control software for **Entra+** to each wall reader and each individual stand alone door lock. The system offers an easy to use and secure access solution ideal for medium to large installations.

FEATURES & BENEFITS

- Centralised card programming using Terminus Windows based software
- Real time card cancellation and logging
- Fault and battery condition reporting
- Up to 64 locks / doors can be controlled by each base station
- Up to 10,000+ user cards per system
- Each card can be programmed with access to doors, groups and areas with time and date validity and shift control
- Base stations use either Ethernet or USB to communicate to the server with a wireless link to the individual door locks
- Door controllers for electric locking can control 2 doors with the same authorities or read in/read out
- ISO printable or pre-printed cards, tokens, etc.
- Cards can be used for multiple sites and multiple applications
- Can be set up remotely or on site
- Interfaces with leading brand PMS systems

TYPICAL SCHEMATIC

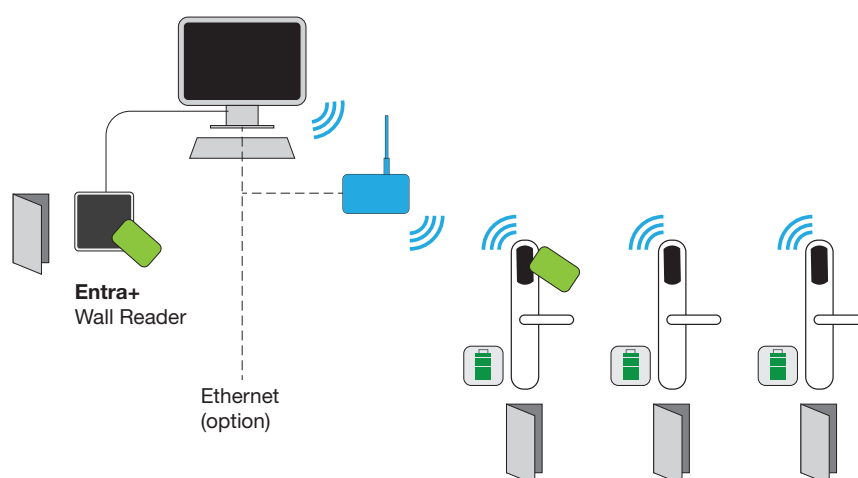

INDOOR SmartEntra

Controllers

The intelligent door controller supports all leading brand readers as well as our own, creating a total solution for your access control application. The controller may be connected to the reader, request to exit and door contacts, with additional auxiliary outputs and a 1.5A 12V lock output. The lock output may be changed on the board with a simple jumper from fail safe to fail secure.

To reduce on-site costs you are able to cable up to 10 controllers via a 46-60vdc bus, eliminating the requirement for a 230v fuse spur at each door. The controller converts the higher voltage down to 12vdc with a 1.5A output to each lock. All controllers have non-volatile memory.

- Up to 25,000 card holders
- Unlimited number of controllers per system
- Unlimited number of doors per system
- RS485 or Ethernet/LAN connection
- 1000 live event log
- 252 trigger events
- Unlimited access levels
- Unlimited timezones

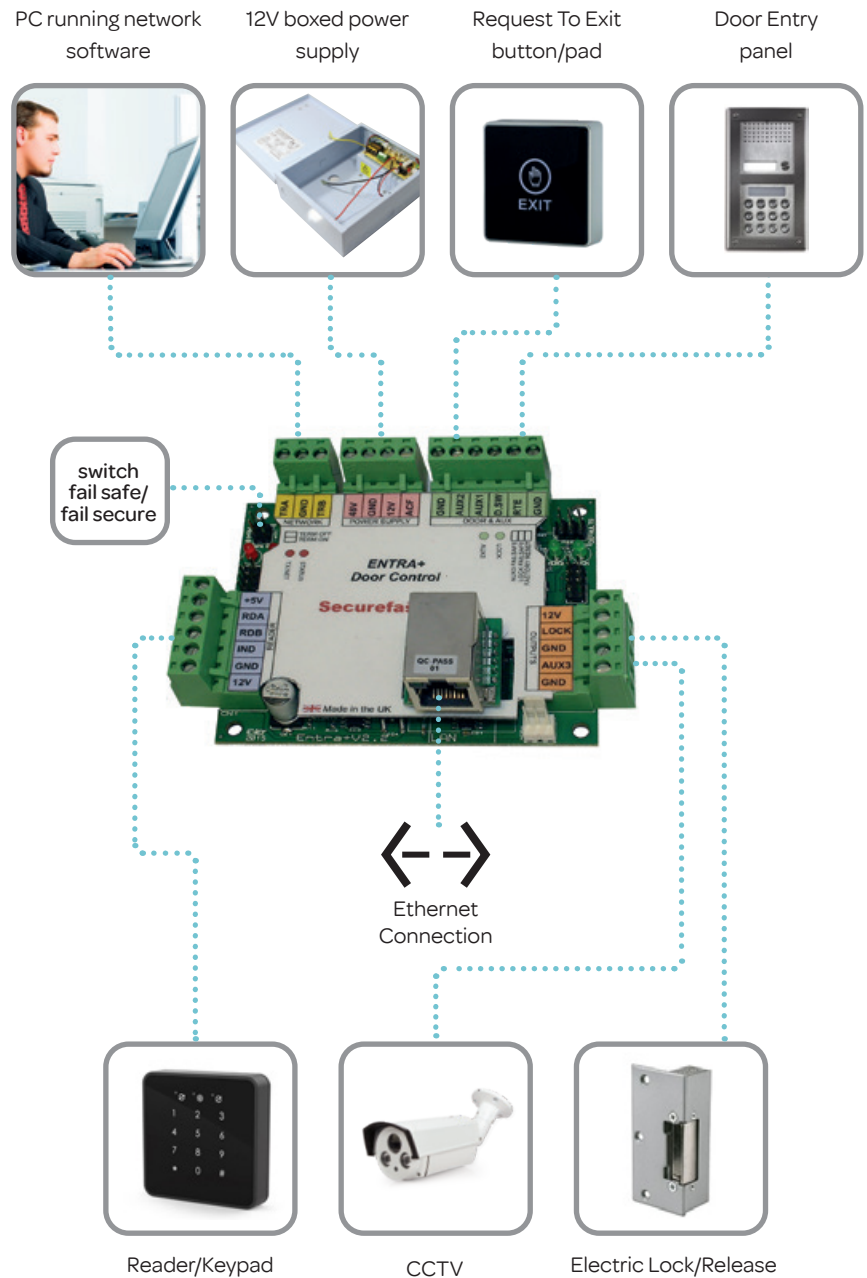

Product code:	Description
AEN2005	Entra+ Single door controller (board only)
AEN2010	Entra+ Single door controller c/w 3A 12v power supply
AEN2020	Entra+ Two door controller c/w 3A 12v power supply
AEN2025	Entra+ Three door controller c/w 3A 12v power supply
AEN2030	Entra+ Four door controller c/w 5A 12v power supply

ACCESS CONTROL • **ENTRA+**

TEL: +44 (0) 1704 502801



Software

Adaptable software suitable for a single door up to a multi-site network of hundreds of doors, gates, barriers and lifts.

The system offers the following primary features:

- Live alarm monitoring of security and fire
- Extensive alarm, transaction, card holder, user log and roll call reports providing essential management and security information as required
- Flexible access and user permissions
- Multiple workstations using TCP/IP access
- Multi-site management
- The ability to use different reader technologies on the same network
- Unlimited networks on the same system
- Unlimited doors on the system
- Up to 25,000 card holders on the system

Entra+ Terminus, software offers a range of options to create a system to suit your application from a basic access control system for a handful of doors through to a truly advanced system with site plans, lift control, building energy control and car park management using the AEN2020 controller. The software options incorporate:

- Access permissions for individuals or user groups
- Administrative rights may be given via any workstation on the network
- Access rights are updated instantly
- Unlimited number of access levels with shift patterns, holidays and visitor permissions on an individual or group level
- Real time event viewing (allowing immediate control and monitoring)
- Fire alarm integration
- Emailed roll call muster report in the event of a fire alarm
- Car park count control and allocation
- Time sheet and reporting
- On-screen site graphics
- Building energy control
- Anti pass-back

14.

www.securefast.co.uk

ACCESS CONTROL



ACCESS CONTROL KITS

To make the specification and installation of access control simpler we have assembled a number of complete kits. This not only avoids that time consuming trip to the wholesaler to pick up a missing item, but ensures that all the components of the system are fully compatible technically.

The range of kits is designed to satisfy the majority of simple stand alone access control applications and contains all the electrical components needed (except cable) to get the system up and running.

Additional fobs/cards can be ordered separately if required, plus any additional brackets which may be required for electromagnetic locks to suit specific door configurations.



SINGLE DOOR ACCESS CONTROL KITS

**AKT4040 Proximity Reader**

Contains:
 APX-18 Proximity reader & 10 fobs
 2000 user capacity
 12V DC 1A power supply
 Slimline magnet
 Exit switch
 Emergency call point

**AKT4042 Proximity Reader**

Contains:
 APX-18 Proximity reader & 10 fobs
 2000 user capacity
 12V DC 1A power supply
 Rim/mortice electric release

**AKT4225 Keypad Internal**

Contains:
 APX-15 Keypad
 12V DC 1A power supply
 Rim/mortice electric release
 Exit switch

**AKT4226 Keypad Internal**

Contains:
 APX-15 Keypad
 12V DC 1A power supply
 Mini magnet
 Exit switch
 Emergency call point

**AKT4227 Keypad External**

Contains:
 APX-16 Keypad
 12V DC 1A power supply
 Mini magnet
 Exit switch
 Emergency call point

**AKT4228 Keypad External**

Contains:
 APX-16 Keypad
 12V DC 1A power supply
 Rim/mortice electric release
 Exit switch

**AKT4229 Keypad Proximity**

Contains:
 APX-16/PROX Keypad & Proximity
 12V DC 1A power supply
 Mini magnet
 Exit switch
 Emergency call point
 10 proximity cards

**AKT4230 Keypad Proximity**

Contains:
 APX-16/PROX Keypad & Proximity
 12V DC 1A power supply
 Rim/mortice electric release
 Exit switch
 10 proximity cards

AKT4041 'NO TOUCH' Kit

For areas of high hygiene where the operator is not required to touch the activating devices.

Contains:
 APX-18 Proximity reader & 10 fobs
 2000 user capacity
 12V DC 1A power supply
 Slimline magnet
 'No Touch' exit switch
 Emergency call point



Product code:	Description
AC7100	Deedlock ISO proximity card, white to suit kits AKT4040, AKT4041, AKT4042
AC7101	Deedlock proximity tag/fob, grey to suit kits AKT4040, AKT4041, AKT4042
AC7101/10	Set of 10 Deedlock proximity tag/fob, grey to suit kits AKT4040, AKT4041, AKT4042
APX16/CARD	Deedlock ISO proximity card for AKT4040, AKT4041, AKT4042, AKT4229 & AKT4230

SINGLE DOOR READERS

Simple, stand alone readers offer card and/or PIN access for individual doors or gates.

Suitable for internal and external applications, each reader provides a lock output suitable for use with any of the **Securefast** electronic locking products (see pages 16 - 46)

APX-11 STANDALONE WiFi KEYPAD

Standalone WiFi keypad with mobile phone App with 10,000 user capability.

- Supports four to six digit PIN
- Works with **eWeLink** App free to download
- Automatic back lit for use in low light conditions
- Adjustable lock relay 0-300 seconds
- Wiegand output to networked system
- Lock output max. 1A
- 12-24V DC power input

For full details please refer to Datasheets.



Product Code	Description	Dimensions (mm)
APX-11	Waterproof WiFi keypad	111 x 46 x 22

SINGLE DOOR ACCESS CONTROL

APX-16 WATERPROOF KEYPAD

A new generation multiple input keypad offering a standard 4-6 digit PIN code with the option to include proximity reader for up to 1200 users.

- Supports PIN only, card only or dual Card & PIN using 125kHz EM proximity cards.
- Rated IP65 for use on all external applications.
- Backlit keypad for use in low light conditions
- Twin lock outputs 2A 24V max.
- 12V - 18V AC or 12V - 24V DC power inputs

For full details please refer to Datasheets.

Product Code	Description	Dimensions (mm)
APX-16	Waterproof keypad	135 x 58 x 18
APX-16/PROX	Waterproof keypad with Proximity reader	135 x 58 x 18
APX-16CARD/10	Pack of 10 proximity cards for APX-16	



APX-16C COMPACT WATERPROOF KEYPAD

A more compact version of the APX-16 with a 4 digit PIN code and waterproof rating of IP65.

- Supports 4 digit PIN and 125kHz EM proximity cards.
- Rated IP65 for use on all external applications.
- Backlit keypad for use in low light conditions
- 12V - 24V DC power inputs
- Lock output max. 1A
- Wiegand 26 output for networked systems
- Lock output current protection

For full details please refer to Datasheets.

Product Code	Description	Dimensions (mm)
APX-16C	Compact waterproof keypad 12-24V DC	129 x 57 x 20
APX-16CARD/10	Pack of 10 proximity cards for APX-16	



APX-12 INTERNAL STANDALONE KEYPAD

A compact, easy to install keypad suitable for up to 2000 users.

- Supports 4 digit PIN code
- Backlit keypad for use in low light conditions
- Adjustable lock relay 0-99 seconds
- Wiegand output to networked system
- Lock output 1A max.
- 12V - 24V DC power inputs

For full details please refer to Datasheets.

Product Code	Description	Dimensions (mm)
APX-12	Internal standalone keypad 12-24V DC	197 x 172 x 20

**APX-14 WATERPROOF STANDALONE KEYPAD**

Polished chrome touch keypad suitable for up to 2000 users.

- Supports 4 digit PIN code
- Touch keypad
- IP68 rating
- Backlit keypad for use in low light conditions
- Adjustable lock relay 0-99 seconds
- Wiegand output to networked system
- Lock output 3A max.
- 12V DC power inputs

For full details please refer to Datasheets.

Product Code	Description	Dimensions (mm)
APX-14	Waterproof standalone chrome touch keypad 12V DC	185 x 185 x 20



ACCESS CONTROL

APX18 STANDALONE 125kHz PROXIMITY READER

A compact, waterproof standalone access control reader which can be programmed for up to 2000 users.

- Programmable via a remote control handset or simply using master Add and Delete cards
- 125kHz EM proximity cards
- Reading range up to 10cm
- IP66 rated for use on all internal or external applications
- 9V - 24V DC power inputs

For full details please refer to Datasheets.

Product Code	Description	Dimensions (mm)
APX18	Waterproof proximity reader - black	103 x 48 x 20
AC7101	Fobs	-
AC7100	Cards	-

**APX19 STANDALONE MIFARE PROXIMITY READER**

A compact, waterproof standalone access control reader using Mifare technology. The reader can be programmed for up to 1000 users.

- Programmable via a remote control handset or simply using master Add and Delete cards
- 13.56MHz Mifare card reader
- Reading range up to 6cm
- IP66 rated for use on all internal or external applications
- 9V - 24V DC power inputs

For full details please refer to Datasheets.

Product Code	Description	Dimensions (mm)
APX19	Waterproof Mifare proximity reader - black	103 x 48 x 20
AMUI-F	Fobs	-
AMUI-C	Cards	-





CHOOSING THE RIGHT LEVEL OF SECURITY

SECURITY GRADING: TS 010:2016

Prepared by the **DHF**, **TS 010:2016** is a Best Practice guide for specifiers of Electromagnetic Locking Devices. Its purpose is to provide a classification of such devices, defining their performance to include test methodology for security, durability, fire and environmental performance. The main purpose is to prove the product, when tested, passes to this specification.

Any additional fire resisting characteristics must be tested in accordance with EN163-1 or EN1634-2

It is expected that products have also been successfully EMC tested for low voltage devices to EN 61000.

8 Digit Classification Code

Products which have undergone testing to TS 010:2016 are given an 8 digit classification code to describe the type of device, its application and its performance. For the purposes of this document we have isolated digits 2 and 6 which are the primary indicators of the lock's physical capabilities.

For further information, please refer to the DHF Best Practice Guide or go to:

www.dhfonline.org.uk

TS 010:2016 Electromagnetic Classification

Digit 1 - Category of Use

Grade 3 - High frequency of use

Digit 2 - Durability

Four categories are identified up to Grade 8 which has undergone 500,000 cycles

Digit 3 - Suitability for Fire/Smoke Doors

Digit 4 - Safety Bolts & Straps

Digit 5 - Corrosion Resistance

Testing to EN 1670

Digit 6 - Security Holding Force without Brackets

Grade 1 - Holding force above 1kN (225lbf)

Grade 2 - Holding force above 2kN (450lbf)

Grade 3 - Holding force above 3kN (675lbf)

Grade 4 - Holding force above 5kN (1125lbf)

Grade 5 - Holding force above 7kN (1575lbf)

Grade 6 - Holding force above 10kN (2250lbf)

Digit 7 - Security - Electrical Function

Digit 8 - Type of Device

ELECTRIC LOCKING

TEL: +44 (0) 1704 502801

UNDERSTANDING ELECTRIC LOCKING

The **Deedlock** range of electronic locking solutions is a comprehensive selection of electromagnetic locks, solenoid bolts, electric releases and electric locks. All are designed for use with any of the Securefast electronic access control systems and audio/video entry systems, **but which one should you choose?**

Each unit is simply a means of holding the door closed and locked until activated (or deactivated) by the card reader etc. Power is normally supplied by the same boxed power supply as for the access control or entry system.

Electromagnetic and solenoid bolt options require an electronic signal to unlock from both sides, e.g card reader from outside and push button from inside. Electric releases and electric locks however can be operated mechanically from one or both sides. This makes them suitable for use on an escape route where egress may be required by lever handle. It also provides a mechanical override capability from outside.

The table below shows the main characteristics for each type of lock. A different locking solution may be selected for each door within your building, selected for maximum security, convenience, safety or simplicity.

For further guidance please contact our technical sales team on:

+44 (0) 1704 502815

	SLIMLINE MAGNETS	STANDARD MAGNETS	SUPERIOR MAGNETS	GATE MAGNET	SHEAR MAGNETS	SOLENOID BOLTS	ELECTRIC LOCK	MORTICE RELEASE	ANSI RELEASE	RIM RELEASE	GATE LOCK
SECURITY GRADE - TS010:2016	2	3	4	3	-	-	-	-	-	-	-
HOLDING FORCE [kN]	2	3	5	3	9	8	9	3.9	4.5	3.9	50
EXTERNAL DOORS		✓	✓	✓	✓		✓		✓		✓
INTERNAL DOORS	✓	✓	✓		✓	✓	✓	✓	✓	✓	
EXTERNAL GATES/BARRIERS				✓							✓
SUIT DOUBLE ACTION DOORS					✓	✓	✓				
FAIL SAFE	✓	✓	✓	✓	✓	✓	✓	✓	✓	✓	✓
FAIL SECURE							✓	✓	✓	✓	✓
MONITORING AVAILABLE	✓	✓	✓	✓	✓	✓	✓	✓	✓	✓	✓
SUITABLE FOR FIRE RATED DOORS	✓	✓	✓		✓		✓		✓		
SURFACE MOUNTING	✓	✓	✓	✓						✓	✓
CONCEALED MOUNTING					✓	✓	✓	✓	✓		



SURFACE MOUNTED ELECTROMAGNETIC LOCKS

Deedlock Face to Face electromagnetic locks are suitable for a wide range of applications used in conjunction with either an access control system or an audio/video entry system. It offers a variety of mounting options suitable for single or double doors.

- Tested to **DHF TS010:2016** technical standard
- Range of size options tested to Security Grade 2, Grade 3 and Grade 4
- Holding forces of 2kN (450 lbf), 3kN (675 lbf), or 5kN (1125 lbf)
- Fire rated option 30 and 60 minute (using intumescent packs)
- Low maintenance with no moving parts
- Simple and quick surface mounted installation
- Suitable for single or double doors
- Range of brackets to suit inward and outward opening door sets
- Dual voltage, 12 or 24V DC selectable on site

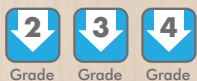

Grade Grade Grade



FD30 FD60

ELECTROMAGNETIC LOCKS



Left, Standard magnet; Above, Slimline magnet

Top, Standard Z & L bracket set
Above, Architectural Z & L bracket set

SIZE AND MOUNTING OPTIONS

Slimline electromagnets (above), Standard and Superior electromagnetic locks can be mounted in a variety of applications, with the use of a range of brackets designed specifically for the magnet. On inward opening doors with Z brackets, a note of caution should be exercised when selecting the best locking option as the increased flexibility in this type of bracket can reduce the holding force of the electromagnet by up to 40%. Please consult our technical sales team for further advice.

Cover brackets are also available for areas where aesthetics are importance of where there is a requirement for anti-ligature.

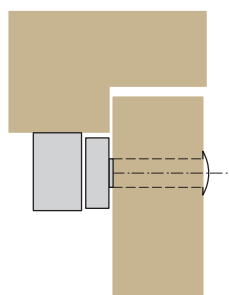
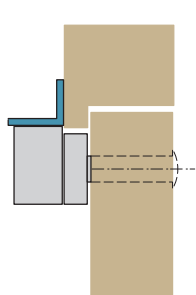
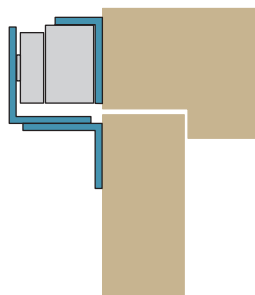
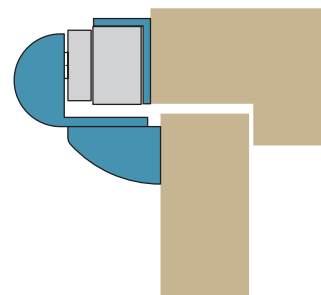
Standard mounting on
outward opening doorMounting with additional
L bracket on shallow
frame section or rebated
overpanelMounted using Z & L
bracket set for inward
opening doorMounted using
architectural Z & L brackets
(illustrated above) for
inward opening door

ELECTROMAGNETIC LOCKS



2kN
(450lbf)
HOLDING FORCE



2kN
(450lbf)
HOLDING FORCE



SLIMLINE ELECTROMAGNETIC LOCKS - GRADE 2 SECURITY

A series of slimline electromagnetic locks suitable for single or double doors. Ideally suited to internal applications where moderate security is required. All versions are site selectable 12/24V DC.

Options include monitored or unmonitored versions. For full details please refer to Datasheets.

Product Code	Description	Monitored	Dual Monitored (Reed Switch)	Dimensions (mm)
AEM10001	Single Slimline electromagnet - Unmonitored	●	●	250 x 47 x 26
AEM10003	Double Slimline electromagnet - Unmonitored	●	●	500 x 47 x 26
AEM10001T	Single Slimline electromagnet (Unmonitored) with Time Delay function	●	●	250 x 47 x 26
AEM10003T	Double Slimline electromagnet (Unmonitored) with Time Delay function	●	●	500 x 47 x 26
AEM10001/KIT	Single Slimline electromagnet (Unmonitored) kit c/w Z & L brackets			
● Available options - refer to Datasheet or Securefast Price List for Product Codes and further details				

BRACKETS AND ACCESSORIES FOR SLIMLINE MAGNETS

For use with single and double Slimline electromagnetic locks. Other options are also available. For further information please refer to Datasheets and Securefast Price List.



Product Code	Description
AEMBR008	Adjustable 'L' bracket
AEMBR089	'Z & L' bracket set for inward opening doors
AEMBR018	Surface armature plate housing
AEMBR185	Armature plate bracket for glass doors
AEMBR186	Glass door bracket for 'L' and 'Z & L' brackets
SINAEM1	Intumescent pack for single magnet

Product Code	Description
AMH590/LA	Architectural 'L' bracket for single magnet
AMH590/DLA	Architectural 'L' bracket for double magnet
AMH590/ZA	Architectural 'Z & L' bracket set
AEMBR019	Flush armature plate housing
AEMAL101	Anti-ligature magnet cover
SINAEM2	Intumescent pack for double magnet

DATASHEETS

ELECTROMAGNETIC LOCKS



Grade

3kN
(675lbf)
HOLDING FORCE



FD30



FD60



Grade

3kN
(675lbf)
HOLDING FORCE



FD30



FD60

STANDARD ELECTROMAGNETIC LOCKS - GRADE 3 SECURITY

A series of electromagnet locks suitable for single or double doors. Ideally suited to internal applications where medium security is required. All versions are site selectable 12/24V DC.

Options include monitored or unmonitored versions. For full details please refer to Datasheets.

Product Code	Description	Monitored	Dual Monitored (Contacts)	Dimensions (mm)
AEM10010	Single electromagnet - Unmonitored	●	●	266 x 73 x 40
AEM10030	Single electromagnet - Dual monitored			266 x 73 x 40
AEM10010T	Single electromagnet (Unmonitored) with Time Delay function	●		266 x 73 x 40
AEM10060	Double electromagnet - Unmonitored	●	●	532 x 73 x 40
● Available options - refer to Datasheet or Securefast Price List for Product Codes and further details				

BRACKETS AND ACCESSORIES FOR STANDARD MAGNETS

For use with single and double standard electromagnet locks. Other options are also available. For further information please refer to Datasheets and Securefast Price List.

AEMBR006



AEMBR026



AEMBR016



AMH595LA



AMH595ZA



AEMBR1006



Product Code	Description
AEMBR006	Adjustable 'L' bracket for outward opening door
AEMBR026	'Z & L' bracket set for inward opening doors
AEMBR016	Surface armature plate housing
AEMBR185	Armature plate bracket for glass doors
AEMBR186	Glass door bracket for 'L' and 'Z & L' brackets
SINAEM1	Intumescent pack for single magnet

Product Code	Description
AMH595/LA	Architectural 'L' bracket for single magnet
AMH595/DLA	Architectural 'L' bracket for double magnet
AMH595/ZA	Architectural 'Z & L' bracket set
AEMBR1006	Universal bracket to suit outward opening door
ADG1-2	Fully adjustable 'L' bracket
SINAEM2	Intumescent pack for double magnet

DATASHEETS

ELECTROMAGNETIC LOCKS



Grade

2kN
(450lbf)
HOLDING FORCE



FD30



FD60



Grade

2kN
(450lbf)
HOLDING FORCE



FD30



FD60



MIDI ELECTROMAGNETIC LOCKS

A series of slimline electromagnetic locks suitable for single or double doors. Ideally suited to internal applications where moderate security is required. All versions are site selectable 12/24V DC.

Options include monitored or unmonitored versions. For full details please refer to Datasheets.

Product Code	Description	Dimensions (mm)
AEM80001	Single Midi electromagnet - Unmonitored	270 x 54 x 28
AEM80002	Single Midi electromagnet - Monitored	270 x 54 x 28
AEM80003	Double Midi electromagnet - Unmonitored	540 x 54 x 28
AEM80004	Double Midi electromagnet - Monitored	540 x 54 x 28

BRACKETS AND ACCESSORIES FOR MIDI MAGNETS

For use on single superior electromagnetic locks. For further information please refer to Datasheets and Securefast Price List.

AEMBR800



AEMBR801



Product Code	Description
AEMBR800	'Z & L' bracket set for inward opening doors
AHM598/ZA	Architectural 'Z & L' bracket set for inward opening doors
AEMBR801	'L' bracket set for outward opening doors
AMH598/LA	Architectural 'L' bracket set for outward opening doors
SINAEM1	Intumescent pack for single magnets (use SINAEM2 for double magnets)

ELECTROMAGNETIC LOCKS



Grade

5kN
(1125lbf)
HOLDING FORCE



FD30



FD60



SUPERIOR ELECTROMAGNETIC LOCKS - GRADE 4 SECURITY

A series of slimline electromagnetic locks suitable for single or double doors. Ideally suited to internal applications where moderate security is required. All versions are site selectable 12/24V DC.

Options include monitored or unmonitored versions. For full details please refer to Datasheets.

Product Code	Description	Dimensions (mm)
AEM12100	Single Superior electromagnet - Unmonitored	288 x 73 x 40
AEM12200	Single Superior electromagnet - Monitored	288 x 73 x 40
AEM12200/DS	Single Superior electromagnet - Monitored with Reed Switch	288 x 73 x 40

BRACKETS AND ACCESSORIES FOR SUPERIOR MAGNETS

For use on single superior electromagnetic locks. For further information please refer to Datasheets and Securefast Price List.

AEMBR012



AEMBR024



AEMBR020



Product Code	Description
AEMBR012	Adjustable 'L' bracket
AEMBR024	'Z & L' bracket set for inward opening doors
AEMBR020	Surface armature plate housing
SINAEM1	Intumescent pack for fire door applications

ELECTROMAGNETIC LOCKS



CE

2kN
(450lbf)
HOLDING FORCE
AEM10000

3kN
(675lbf)
HOLDING FORCE
AEM12000

MORTICE ELECTROMAGNETIC LOCK

A series of mortice mounted electromagnetic locks. Ideally suited to internal applications where medium security is required. All versions are site selectable 12/24V DC.

Options include monitored or unmonitored versions. For full details please refer to Datasheets.

Product Code	Description	Dimensions (mm)
AEM10000	Single mortice electromagnet - Unmonitored	228 x 38 x 27
AEM10000R	Single mortice electromagnet - Monitored	228 x 38 x 27
AEM12000	Single mortice electromagnet - Unmonitored	228 x 38 x 27
AEM12000R	Single mortice electromagnet - Monitored	228 x 38 x 27

ELECTROMAGNETIC LOCKS



2kN
(450lbf)
HOLDING FORCE
AEM/MINGATE

3kN
(675lbf)
HOLDING FORCE
AEMGATE

EXTERNAL ELECTROMAGNETIC GATE LOCK

A series of surface mounted electromagnetic locks. Ideally suited to external gate applications where medium security is required. All versions are site selectable 12/24V DC. Reed switch monitoring.

For full details please refer to Datasheets.

Product Code	Description	Dimensions (mm)
AEMGATE/F/S	Side or face fixed electromagnetic gate lock - monitored	222 x 63 x 40
AEM/MINGATE/F/S	Side or face fixed electromagnetic mini gate lock - monitored	203 x 44 x 38.5

BRACKETS AND ACCESSORIES FOR GATE MAGNETS

For use on single electromagnetic gate locks. For further information please refer to Datasheets and Securefast Price List.

AEMBR046



AEMBR056



Product Code	Description
AEMBR046	'Z' bracket for AEMGATE/F/S
AEMBR056	'Z' bracket for AEM/MINGATE/F/S

ELECTROMAGNETIC LOCKS

ELECTROMAGNETIC LOCKS IN HOUSINGS

Designed for use either across the head frame or down the opening jamb of a timber or metal door, the **Deedlock** range of mortice magnets are encased in a satin anodised aluminium housing, providing a clean, uninterrupted profile to your door opening.

- Tested to **DHF TS010:2016** standard
- Security Grade 2 with a holding force of 2kN (450lbf)
- Ideal solution for sliding door applications
- Fire rated option (using intumescent packs)
- Simple and quick surface mounted installation
- Available in a range of lengths to suit transom or jamb installation
- Units are supplied complete with housing, magnet(s) and armature plate(s)
- Dual voltage, 12 or 24V DC selectable on site



Grade



FD30



FD60



ELECTROMAGNETIC LOCKS



2kN
(450lbf)
HOLDING FORCE
SLIMLINE



3kN
(675lbf)
HOLDING FORCE
STANDARD



ELECTROMAGNETIC LOCKS IN HOUSING - GRADE 2 & 3 SECURITY

A series of electromagnetic locks within a vertical or horizontal aluminium housing and suitable for single or double doors. Ideally suited to internal applications where moderate security is required. All versions are site selectable 12/24V DC.

Options include monitored and unmonitored versions. For full details please refer to Datasheets.

Product Code	Description & Application	Monitored	Dimensions (mm)
AMG201/UM	Grade 2 Single Slimline electromagnet - Unmonitored	●	175 x 45 x 33
AMG202/UM	1 metre transom housing with 1 No. AMG201 magnet (Unmonitored) for single door	●	1000 x 45 x 33
AMG203/UM	320mm transom housing with 1 No. AMG201 magnet (Unmonitored) for single door	●	320 x 45 x 33
AMG204/UM	1.5 metre transom housing with 2 No. AMG201 magnets (Unmonitored) for double door	●	1500 x 45 x 33
AMG205/UM	2 metre vertical housing with 2 No. AMG201 magnets (Unmonitored) for single door	●	2000 x 45 x 33
AMG206/AT	2 metre transom housing with 1 No. AMG201 magnet (Monitored) for double door where one leaf is bolted top and bottom		2000 x 45 x 33
AMG207/UM	2 metre transom housing with 2 No. AMG201 magnets (Unmonitored) for double door	●	2000 x 45 x 33
	● Available option - refer to Datasheet or Securefast Price List for Product Codes and further details		
AMG211/AT	1 metre transom housing with 1 No. AMG211 magnet - Grade 3 (Monitored) for single door		1000 x 67 x 40
AMG215/AT	2 metre transom housing with 2 No. AMG211 magnet - Grade 3 (Monitored) for double door		2000 x 67 x 40

BRACKETS AND ACCESSORIES FOR MAGNETS IN HOUSING

A series of brackets are available to allow transom housings to be fixed to shallow headers.

AMH592/L320



Product Code	Description
AMH592/L1	1 metre transom 'L' bracket for AMG202 or AMG206/AMG207 using 2 brackets per magnet
AMH592/L2	2 metre vertical bracket for AMG205/AT or AMG205/UM only
AMH592/L320	320mm 'L' bracket for AMG203 transom housing
SINAEM1	Intumescent pack for single magnets (use SINAEM2 for double magnets)

DATASHEETS

DS15-003

DS15-014



ELECTROMAGNETIC SHEAR LOCKS

Shear locks provide exceptional holding force due to a central shear pin which effectively locks the magnet and armature together. The lock is installed into the door frame and the door with no visible sign when the door is locked. The locks are available either surface mounted or mortice mounted.

- Very high holding force up to 9.5 kN (2135 lbf)
- Can be used on single swing and double swing doors
- Suitable for timber, aluminium or steel doors
- Fire rated option (using intumescent packs) tested to EN1634-1
- Simple and quick surface mounting options
- Suitable for horizontal or vertical mounting
- Fixing kit for glass doors available with surface kit
- Dual voltage, 12 or 24V DC selectable on site

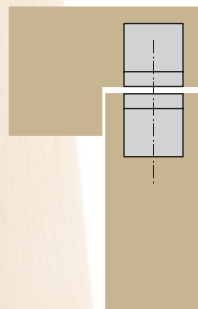

Mortice mounted
Single action door

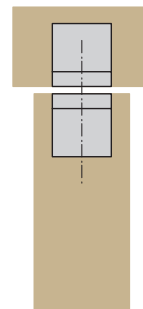

Mortice mounted
Double action door

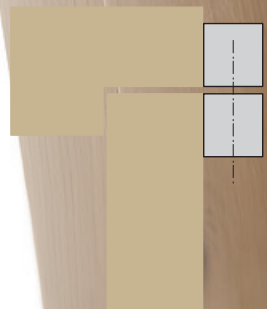

Surface mounted
Single action door



ELECTROMAGNETIC LOCKS

ELECTROMAGNETIC SHEAR LOCKS

A selection of mortice or surface mounted shear locks which offer high holding force and suitable for single or double swing, single or double doors. Suitable for mounting in the head frame or vertical jamb.

For full details please refer to Datasheets.



9.5kN
(2135lbf)
HOLDING FORCE



Product Code	Description & Application	Dimensions (mm)
AEMSF300	FIRE RATED mortice shear magnet (Monitored) - with 8.9kN (2000 lbf) holding force (30mm wide)	266 x 30 x 33
AEM/SHEAR -30	Mortice shear magnet (Monitored) - with 8.9kN (2000 lbf) holding force (30mm wide)	266 x 30 x 33
AEM/SHEAR -35	Mortice shear magnet (Monitored) - with 9.5kN (2135 lbf) holding force (35mm wide)	266 x 35 x 33



Product Code	Description & Application	Dimensions (mm)
AMS41SFM	Compact mortice shear magnet (Monitored with separate PCB) - with 9500N holding force	266 x 30 x 33
AMS41SSM	Compact surface mounted shear magnet (Monitored with separate PCB) - with 9500N holding force	266 x 30 x 33

ACCESSORIES FOR SHEAR MAGNETS

Product Code	Description
AGS705/SUR	Surface housing to suit AEM/SHEAR-30 electromagnetic lock
AMS41GF-KIT	Magnetic Solutions bracket for AMS41SSM for installation on glass doors (2 required if fitting to glass door and frame)
AMSGFAD	Magnetic Solutions Adhesive for Glass Door Bracket

ELECTRIC LOCKS & SOLENOID BOLTS

These normally mortice mounted locks provide a high level of security with exceptional holding force. Both types are suitable for single and double swing doors and can be mounted in the horizontal or vertical position on the transom or jamb of a timber, aluminium or steel door.

- Very high holding force up to 10kN (2250 lbf)
- Can be used on single swing and double swing doors
- Suitable for timber, aluminium or steel doors
- Dual monitoring of door and bolt position
- Solenoid bolts have variable auto relock time
- Electric locks are designed to operate under side load
- Fire tested to EN 1634-1 (check details opposite)
- 12V DC operation



SOLENOID BOLTS

SOLENOID BOLTS

A series of fail unlocked solenoid bolts with very high holding force suitable for any high security application. Suitable for mounting in the head frame or vertical jamb.

For full details please refer to Datasheets.



8.5kN
(1990lbf)
HOLDING FORCE



Product Code	Description & Application	Dimensions (mm)
AER134	Mortice mounted solenoid bolt - 12V DC fail unlocked - Dual monitored	210 x 38 x 34
AER134H	Surface housing for AER134	
AER195G/F	Surface housing glass fixing kit	



8.5kN
(1990lbf)
HOLDING FORCE



Product Code	Description & Application	Dimensions (mm)
AER180	Slimline mortice mounted solenoid bolt - 12V DC fail unlocked - Dual monitored	210 x 43 x 25

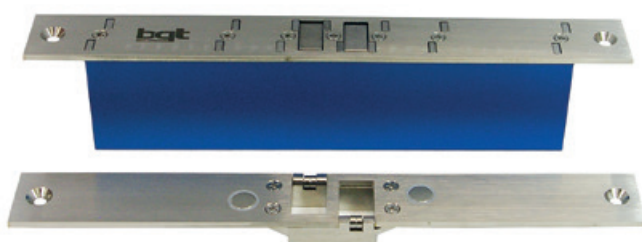

10kN
(2250lbf)
HOLDING FORCE



Product Code	Description & Application	Dimensions (mm)
ASA66	Single action motor driven electric lock	160 x 30 x 51
ADA66	Double action motor driven electric lock	255 x 30 x 51
ASA66/H	Surface housing and dress plate to suit ASA66 (2 required to surface mount lock and strike)	
ADA66/H	Surface housing and dress plate to suit ADA66 (2 required to surface mount lock and strike)	
SIN-ASA66	Intumescent pack for ASA66	
SIN-ADA66	Intumescent pack for ADA66	

ELECTRIC LOCKS

ELECTRIC LOCKS

High performance mortice mounted lockcase for single or double swing doors. The narrow lock profile enables it to be used in narrow door stiles. Stainless steel construction with optional cylinder override, the lock will be automatically deadlocked when the door closes.

Tested to 1 million cycles and RoHS compliant.

For full details please refer to Datasheets.



8.9kN
(2000lbf)
HOLDING FORCE



Product Code	Description & Application
AML-300-SW	Mortice electric lock (vertical mounting only) - Fail Safe or Fail Secure selectable on-site Supplied with strike plates for single and double action door
	Dimensions 275 x 44 x 25mm

ELECTRIC LOCKS - PRELOAD RELEASE

High performance mortice mounted lockcase for double swing doors. The narrow lock profile enables it to be used in narrow door stiles and can be mounted horizontally or vertically. The lock will release even under a side load of up to 2,200N to overcome air pressure differences or warped doors or seals.

For full details please refer to Datasheets.



6.7kN
(1500lbf)
HOLDING FORCE



Product Code	Description & Application
AML-350M-PL-12	Mortice electric lock double swing doors - Fail Safe or Fail Secure selectable on-site Fire tested to EN 1634-1 for timber doors up to FD60
	Dimensions 200 x 40 x 25mm

SLIDING DOOR LOCK

Specially designed for sliding doors, the lock is installed into the frame with the auto locking latch into the door edge.

For full details please refer to Datasheets.



8kN
(1800lbf)
HOLDING FORCE



Product Code	Description & Application
AEL23822FG	Sliding door lock with auto locking latch
	Dimensions 150 x 54 x 25mm

ELECTRIC LOCKS

ELECTRIC MORTICE SASHLOCK

The electric lock has a magnetic latch which is thrown when the lock is aligned with the striker plate and has the benefit of no lip on the striker meaning the door can close into the frame with no side pressure. The deadbolt then automatically relocks after 3 seconds from when the latch throws into position.

60mm backset for key override function by Euro profile cylinder.

For full details please refer to Datasheets.

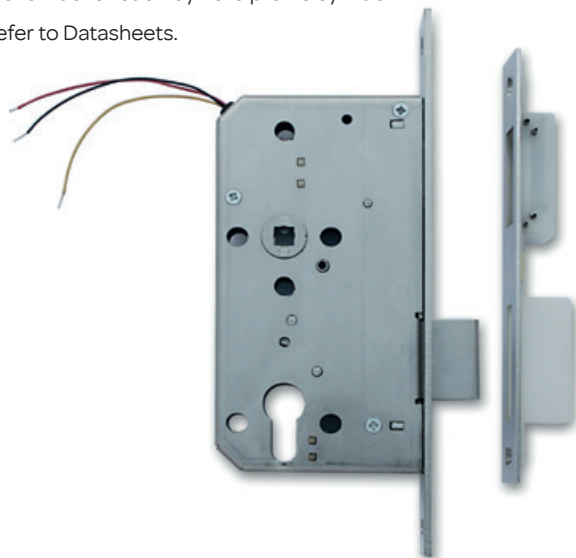

Patented
Pat. No GB2516950A

Product Code	Description & Application	Dimensions (mm)
ASEL2460	Electric escape sashlock with automatic deadbolt and key override option	210 x 38 x 34

ELECTRIC GATE LOCK

For maximum security, the AGL66 lock offers a holding force of 50kN operating on 12V or 24V DC. With an IP rating of IP67 and built in heater for working temperatures of -35°C, the AGL66 is suitable for all harsh external applications. Available fail safe and fail secure via Dip Switch.

For full details please refer to Datasheets.



50kN
(11,250lbf)
HOLDING FORCE



Product Code	Description & Application	Dimensions (mm)
AGL66	Gate and roller door lock - 50kN holding force	210 x 43 x 25

DATASHEETS

DS1-001

DS1-015

ELECTRIC RELEASES OR STRIKES

Electric releases are used in conjunction with a conventional mortice or rim latch. They allow the door to be operated on the inside either by lever handle or exit device, making them ideal for use on escape routes. Always ensure you use a deadlock rim or mortice latch with all electric releases.

- Suitable for timber, aluminum or metal door sets
- Can be used on inward or outward opening single swing doors
- Suitable for use with mortice or rim night latches (see chart)
- CE marked and fire rated versions for use on FD30 and FD60 fire doors (see chart)
- Available fail locked (secured) or fail unlocked (Open)
- 12V and 24V DC operation



ELECTRIC RELEASES

**Mortice Releases**

Designed for use with mortice locks and latches, the mortice electric release is fitted in place of the normal strike plate on timber or metal doors. Generally suitable for outward opening doors.

Versions are available for use with sash locks for additional security

**ANSI Mortice Releases**

ANSI mortice releases have an additional lip on the opening face which protects the recessed edge of the door frame. It provides additional holding force with a cleaner appearance and smoother operation.

**Rim Releases**

Rim mounted electric releases are designed specifically for use with conventional rim nightlatches on inward opening doors. They are surface mounted on the frame in place of the keep supplied with the nightlatch.

SELECTION ADVICE

Selecting the most appropriate release depends on many different criteria and their relative importance in each application. In general the following aspects should be considered:

Door/Frame type - Fitting to wood and metal doors

Lock type - Rim or mortice; nightlatch or sash lock etc.

Release type - Match the release type to lock type *

Configuration - For inward or outward opening application

Safety - Fail Locked [Secure] or Fail Unlocked [Safe]

Security - Higher holding forces offer higher physical security

Usage - Select for low or medium traffic

Operating voltage - For 12v or 24v - AC or DC

Additional features - Including monitoring

* During the selection process, the size and throw of the latch must be checked against the depth of the release to ensure the latch throws fully into the keep. When used with Securefast lock cases please see the **COMPATIBILITY CHART** on page 46.

ELECTRIC RELEASES

AL900 SERIES

A series of ANSI type releases for metal or timber frames. Designed to work with most leading brand mortice night latches.

- Fire rated for FD30 and FD60 timber doors
- 4.45kN holding force
- Supplied Fail Secure/Locked but changeable on site to Fail Safe/Unlocked
- Stainless steel long and short faceplate
- 12/24V AC/DC selectable on site
- Monitoring options



4.45kN
(1000lbf)
HOLDING FORCE



FD30



FD60

For full details please refer to Datasheet.

Product Code	Description	Max. latch projection
AL900	Fail locked/Fail unlocked ANSI style release - Unmonitored	15mm
AL900M	Fail locked/Fail unlocked ANSI style release - Monitored latch	15mm
AL900DM	Fail locked/Fail unlocked ANSI style release - Monitored latch and door position	15mm

AL990M

High Security electric release with high holding force. The release can be switched from fail safe to fail secure without removing the release from the door frame.

- 6.67kN holding force
- Door and keep monitoring
- 12-24V DC power input
- Suitable for metal or timber doors
- Heavy duty steel construction



6.67kN
(1500lbf)
HOLDING FORCE



FD30



FD60

For full details please refer to Datasheet.

Product Code	Description	Max. latch projection
AL990M	Securefast high security electric release with door and keep monitoring	175 x 29 x 27mm

ELECTRIC RELEASES

Deedlock AH111 SERIES

A series of ANSI type releases designed for use in hollow metal frames.

- CE marked
- 4450N holding force
- Site selectable for Fail Safe/Fail Secure
- Supplied with short and long stainless steel faceplates
- 12/24V DC selectable on site
- Lip extensions available

For full details please refer to Datasheets.



4.45kN
(1000lbf)
HOLDING FORCE



Product Code	Description	Max. latch projection
AH111	Fail locked/Fail unlocked ANSI style release - Unmonitored - 12/24V DC	15mm
AH111M	Fail locked/Fail unlocked ANSI style release - Unmonitored - 12V DC only	15mm

Deedlock ANSI SERIES

A series of ANSI type releases suited to low to medium traffic applications.

- 4450N holding force
- Available Fail Safe or Fail Secure
- Supplied with short and long faceplates
- Dual monitored option
- 12V DC

For full details please refer to Datasheets.



4.45kN
(1000lbf)
HOLDING FORCE

Product Code	Description	Max. latch projection
AST125-FLT	Fail locked ANSI style release - Unmonitored - 12V DC	15mm
AST125-FUT	Fail unlocked ANSI style release - Unmonitored - 12V DC	15mm

Dorcas MORTICE SERIES

A series of mortice releases suitable for use with sashlocks. Suitable for low to medium traffic applications.

- Suited to timber door and frame applications
- Up to 3900N holding force
- Available Fail Secure/Locked
- Stainless steel faceplate
- DIN handed
- 12V DC

Note: The electric release will ONLY release the lock's latchbolt. The deadbolt must be released manually by cylinder.

For full details please refer to Datasheet.



3.9kN
(875lbf)
HOLDING FORCE

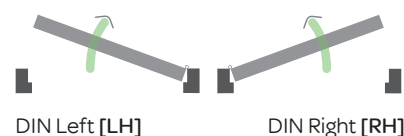

Product Code	Description	Max. latch projection
ADCN412GE-LH	Fail locked electric release for timber doors/frames - Left Hand	12mm
ADCN412GE-RH	Fail locked electric release for timber doors/frames - Right Hand	12mm

Deedlock uPVC SERIES

Mortice sashlock release designed to replace the centre latch and deadbolt keep of locks fitted to uPVC door frames.

- Electronic control of latchbolt
- Suitable for low to medium traffic
- Up to 3900N holding force
- Fail Secure/Locked
- Stainless steel faceplate
- 12V AC or DC

For full details please refer to Datasheet.



3.9kN
(875lbf)
HOLDING FORCE

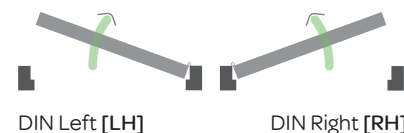

Product Code	Description	Max. latch projection
AXK21L8	Fail locked release for sashlocks fitted to uPVC door frames - Left Hand	12mm
AXK21R8	Fail locked release for sashlocks fitted to uPVC door frames - Right Hand	12mm

ELECTRIC RELEASES

Dorcas TIMBER DOOR RANGE

A comprehensive range of cost effective electric releases designed for use with mortice nightlatches and latches fitted to timber doors and frames.

- Suitable for timber doors on low to medium traffic applications
- Up to 3900N holding force
- Universal for left or right hand doors inward or outward opening
- Fail Secure and Fail Safe options
- Stainless steel faceplate
- Available to suit 12V AC or DC and 24V DC
- 'Remain open' function available



3.9kN
(875lbf)
HOLDING FORCE

Product Code	Description	Voltage	Max. latch projection
ADCNG	Fail locked release	12V AC	12mm
ADCN412G	Fail locked release - Continuously rated	12V DC	12mm
ADCN512G	Fail unlocked release - Continuously rated	12V DC	12mm
ADCN412G-FLEX	Fail locked release with adjustable jaw - Continuously rated	12V DC	12mm
ADCN512G-FLEX	Fail unlocked release with adjustable jaw - Continuously rated	12V DC	12mm
ADCN424G	Fail locked release - Continuously rated	24V DC	12mm
ADCN524G	Fail unlocked release - Continuously rated	24V DC	12mm

Dorcas HIGH HOLDING FORCE

Mortice release with very high holding force.

- Suited to timber door and frame applications
- Suitable for medium traffic inward or outward opening doors
- Up to 7800N holding force
- Fail Secure/Locked
- Stainless steel faceplate
- Available for 12V AC or 12V DC



7.8kN
(1750lbf)
HOLDING FORCE

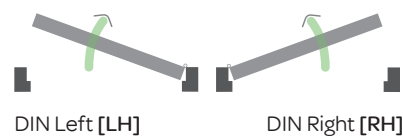

For full details please refer to Datasheet.

Product Code	Description	Max. latch projection
ADCN50N-PX	Fail locked electric release for timber doors/frames - 12 V AC systems	12mm
ADCN50N400-PX	Fail locked electric release for timber doors/frames - 12 V DC systems	12mm

DATASHEETS

DS2-006

DS2-009

ELECTRIC RELEASES

Deedlock RIM SERIES

Rim mounted release for use with rim nightlatches on inward opening doors.

- CE marked release
- Suitable for timber doors and frames
- Up to 4450N holding force
- Fail Secure/Locked or Fail Safe/Unlocked selectable on-site
- 12V DC
- Black finish with stainless steel jaw



4.5kN
(1000lbf)
HOLDING FORCE



For full details please refer to Datasheet.

Product Code	Description	Max. latch projection
AH113	Rim electric release - Site selectable for Fail locked / Fail unlocked	15mm

Dorcas RIM SERIES

A range of cost effective Dorcas releases for use with rim nightlatches and latches.

- Suited to inward opening timber door and frame applications
- For low to medium traffic applications
- Can be used with mortice faceplate on outward opening doors
- Up to 3900N holding force
- Fail Secure/Locked or Fail Safe/Unlocked versions
- Grey powder coated finish
- Available for 12V AC or 12V DC



3.9kN
(875lbf)
HOLDING FORCE

For full details please refer to Datasheet.

Product Code	Description	Max. latch projection
ADCN203+S	Fail locked rim or mortice mounted release - 12V AC/DC	12mm
ADCN203+S/FLEX	Fail locked rim or mortice mounted release with adjustable jaw - 12V AC/DC	12mm
ADCN203-412+S	Fail locked rim or mortice mounted release - 12V DC - continuously rated	12mm
ADCN203-512+S	Fail unlocked rim or mortice mounted release - 12V DC	12mm
ADCN203-412+S/FLEX	Fail locked rim or mortice mounted release with adjustable jaw - 12V DC - continuously rated	12mm
ADCN203-512+S/FLEX	Fail unlocked rim or mortice mounted release with adjustable jaw - 12V DC	12mm

ELECTRIC RELEASES

Dorcas RIM SERIES

A range of cost effective Dorcas releases for use with conventional rim nightlatches.

- Suited to inward opening timber door and frame applications
- For low to medium traffic applications
- Up to 3900N holding force
- Fail Secure/Locked or Fail Safe/Unlocked versions
- Grey powder coated finish
- Available for 12V AC or 12V DC



3.9kN
(875lbf)
HOLDING FORCE

For full details please refer to Datasheet.

Product Code	Description	Max. latch projection
ADCN203G	Fail locked rim mounted release for rim nightlatch- 12V AC	12mm
ADCN203-412G	Fail locked rim mounted release for rim nightlatch- 12V DC	12mm
ADCN203-512G	Fail unlocked rim mounted release for rim nightlatch- 12V DC	12mm

ELECTRIC RELEASE COMPATIBILITY

Securefast electric releases are compatible with the following Securefast lock cases.

Releases are listed alphanumerically.

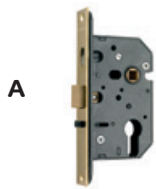

A

Euro profile UK
format nightlatch
SEU511 / 512 / 513
/ 514

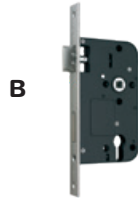

B

Euro profile 72mm
centres nightlatch
SEU777

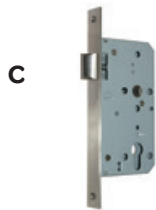

C

Euro profile latch
SEU1092
SEU1094



D

Scandinavian
nightlatch
SA8762



E

Euro profile
Scandinavian
nightlatch
SA393



F

Heavy duty tubular
latch
SLA520



G

Alpro round cylinder
nightlatch
A5245101
A5245102
A5245103
A5245104



H

Alpro Euro profile
cylinder nightlatch
A5245701
A5245702
A5245703
A5245704



I

Adams Rite round
cylinder nightlatch
AAR4710-100
AAR4710-200
AAR4710-300
AAR4710-400



J

Adams Rite Euro
profile nightlatch
AAR4750-100
AAR4750-200
AAR4750-300
AAR4750-400



K

Rim nightlatch

Release Code:	Release Type	For Lock Cases
AL900 & AL900M	ANSI mortice release	A to J
ADCAG	Mortice release	A; B; C
ADCN50NPX	ANSI mortice	A to J
ADCN50N400PX	ANSI mortice	A to J
ADCN203G	Rim release	K
ADCN203+S	Rim release - mortice plate	F; K
ADCN203-412G	Rim release	K
ADCN203-412+S	Rim - mortice plate	F; K
ADCN203+S/FLEX	Rim release- adj. jaw	F; K
ADCN203-512G	Rim release	K
ADCN203-512+S	Rim release - mortice plate	F; K
ADCN203-512+S/FLEX	Rim release - adj. jaw	F; K
ADCN412G	Mortice release	A; B; C; F
ADCN412G-FLEX	Mortice release - adj. jaw	A; B; C; F
ADCN412G/L/R	Sashlock release	A; B; C; F
ADCN424G	Mortice release	A; B; C; F
ADCN512G	Mortice release	A; B; C; F
ADCN512G-FLEX	Mortice release- adj. jaw	A; B; C; F
ADCN524G	Mortice release	A; B; C; F
ADCNG	Mortice release	A; B; C; F
ADCNG-FLEX	Mortice release - adj. jaw	A; B; C; F
AH111 & AH111M	ANSI - short & long faceplates	A; D; E; F; G; H; I; J
AH113	Rim for inward opening doors	K
AST125-FLT	ANSI mortice - short & long faceplates	A; D; E; F; G; H; I; J
AST125-FUT	ANSI mortice - short & long faceplates	A; D; E; F; G; H; I; J
AXKZ1LB/RB	Sashlock release	B; C



ELECTRONIC SYSTEM ACCESSORIES

To complete an access control system or door entry system for example, a series of additional components may be required. These may be a combination of any of the following:

- Power supply units to provide low voltage power
- Electronic release buttons to allow instant activation of electronic locking
- Call points and emergency releases which provide safety links to building fire and smoke detection or alarm systems
- Power loops which will transfer power from frames to doors

TOUCH SENSITIVE EXIT BUTTONS

A range of architectural touch sensitive buttons with backbox for surface mounting.

These buttons can be used to activate automatic doors or to control electronic locking as part of an access control or door entry system.

- Available in black or ivory with blue LED lighting
- Blue LED changes to Green when activated
- Sensor is activated by hand or finger
- Standard single gang or mullion style
- 12V DC

For full details please refer to Datasheet.



AEB513 - AEB516

Product Code	Description	Dimensions (mm)
AEB513	Touch sensitive button - Black with blue LED standby	86 x 56
AEB514	Touch sensitive button - Black with blue LED standby	86 x 86
AEB515	Touch sensitive button - White with blue LED standby	86 x 56
AEB516	Touch sensitive button - White with blue LED standby	86 x 86

TOUCH SENSITIVE & 'NON TOUCH' EXIT BUTTONS

A range of touch and non touch exit buttons suitable for recessed or surface mounting.

These buttons can be used to activate automatic doors or to control electronic locking as part of an access control or door entry system.

- 28mm diameter touch sensitive button
- Illuminated button for use in low light areas
- 4mm aluminium plate mounted (AEB508/509)
- 12V DC
- AEB37 is a 'Non Touch' hygienic exit switch with a reading range of 10cm

For full details please refer to Datasheet.



AEB508/509



AEB37



Product Code	Description	Dimensions (mm)
AEB508	Aluminium touch sensitive button - With blue LED standby	86 x 86
AEB509	Aluminium touch sensitive button - With blue LED standby	86 x 50
AEB37	Stainless steel 'Non Touch' exit button c/w green surface mount back box and timer	86 x 86

ACCESS CONTROL ACCESSORIES

STAINLESS STEEL EXIT BUTTONS

A range of stainless steel request to exit buttons suitable for surface or flush mounting.

These buttons can be used to activate automatic doors or to control electronic locking as part of an access control or door entry system.

- CE compliant
- Tested to 500,000 operations
- Switch rated 3A at 12/24V DC

For full details please refer to Datasheet.



AEB501/502



AEB503/504

Product Code	Description	Dimensions (mm)
AEB501	Stainless steel 'Press to Exit' button with Green LED - Flush mounted	86 x 86
AEB502	Stainless steel 'Press to Exit' button with Green LED - Flush mounted	115 x 40
AEB503	Stainless steel 'Press to Exit' button - Flush mounted	86 x 86
AEB504	Stainless steel 'Press to Exit' button - Flush mounted	115 x 40
AEB503/B	Stainless steel 'Press to Exit' button as AEB503 with Green surface mount box	86 x 86
AEB504/B	Stainless steel 'Press to Exit' button as AEB504 with Green surface mount box	115 x 40

STAINLESS STEEL EXIT BUTTONS

A range of stainless steel domed request to exit buttons suitable for surface or flush mounting.

- CE compliant
- Switch rated 3A at 12/24V DC
- Rated IP65

For full details please refer to Datasheet.



AEB505/506/507

Product Code	Description	Dimensions (mm)
AEB505	Stainless steel 'Press to Exit' button with Green Domed button - Flush mounted - Rated IP65	86 x 86
AEB506	Stainless steel 'Press to Exit' button with Green Domed button - Flush mounted - Rated IP65	86 x 86
AEB507	Stainless steel 'Press to Exit' button with Green Domed button - Flush mounted - Rated IP65	115 x 40
AEB505/B	Stainless steel 'Press to Exit' button with Green Domed button - With Green surface mount box	86 x 86
AEB506/B	Stainless steel 'Press to Exit' button with Green Domed button - With Green surface mount box	86 x 86
AEB507/B	Stainless steel 'Press to Exit' button with Green Domed button - With Green surface mount box	115 x 40

LARGE EXIT PUSH PADS

A range of stainless steel exit buttons with large green circular push pads.

These buttons are ideal for high volume traffic in public buildings to activate automatic doors or as part of an access control or door entry system.

- Stainless steel plate with green push pad
- IP65 rated
- Supplied with green surface mounted back box
- May be flush mounted on standard single gang back box
- 12V DC



Product Code	Description	Dimensions (mm)
AEB510	Stainless steel plate with large green disc/button 'EXIT'	88 x 88 x 40
AEB511	Stainless steel plate with large green disc/button 'PUSH TO EXIT'	88 x 88 x 40
AEB512	Stainless steel plate with large green disc/button 'PUSH TO OPEN' with WHEELCHAIR SYMBOL	88 x 88 x 40
AEB10	Stainless steel narrow 'PUSH TO OPEN' switch with WHEELCHAIR SYMBOL	45 x 110 x 45

PLASTIC EXIT BUTTONS

A range of surface mounted plastic request to exit buttons.

- 10A at 240V AC/DC
- Changeover contacts
- Suitable for internal use only



Product Code	Description	Dimensions (mm)
AEB1	Stainless steel narrow exit button - NO-COM only	80 x 30 x 20
AEB1NR	White plastic exit button c/w surface mount box - 'PRESS TO EXIT'	86 x 86
AEB8	Narrow white plastic exit button c/w surface mount box - 'PRESS TO EXIT'	86 x 40
AEB17	White plastic and green dome exit button c/w surface mount box - 'PRESS TO EXIT'	86 x 86
AEB17/DR	White plastic and green dome exit button c/w surface mount box - 'DOOR RELEASE'	86 x 40

ACCESS CONTROL ACCESSORIES

PANIC EXIT RELEASE

Especially suited to use as a request to exit device on an escape door which is fitted with electromagnetic lock.

The touch bar panic exit device is compliant with EN 1125 and suitable for use on single and double door combinations.

- CE compliant to EN 1125 / EN 13637
- Ideal for use with electromagnetic surface mounted magnets
- Can be cut down on site to suit door widths from 1240mm to 365mm
- Dual switching for lock activation and monitoring
- 12 or 24V DC, max 5A



For full details please refer to Datasheet.

Product Code	Description
AEB800	Touch bar panic actuator with micro switch

MANUAL CALL POINTS

A series of resettable call points. The lift up cover prevents accidental activation, a major cause of false alarms.

These surface mounted units provide immediate unlocking in the event of an emergency.

- Double or triple pole change over contacts
- Resettable by key
- Transparent hinged cover



ACP320/G

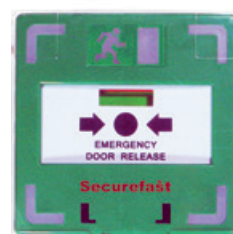

ACP350



ACP501

For full details please refer to Datasheets.

Product Code	Description	Dimensions (mm)
ACP320/G	Resettable double pole call point with built in status display (Locked/Unlocked) - 5A rating at 125/250V AC	87 x 91 x 53
ACP350	Resettable triple pole call point with dual light activation and alarm sounder - 12-24V DC, 5A rating at 125/250V AC	90 x 90 x 40
ACP501	Resettable call point - CE marked and tested to 100,000 operations - 3A rating at 36V DC max.	86 x 86 x 55

DATASHEETS

DS5-011

DS5-012

DS5-016

POWER TRANSFER LOOPS

Door loops allow you to transfer cables from the door frame to the door.

- Concealed and surface options
- Suitable for single action doors
- ALP101 is fire rated to FD30 and FD60

For full details please refer to Datasheet.



Product Code	Description	Dimensions (mm)
ALP101	Concealed door loop - Fire rated FD60	288 x 24 x 17
ALP103	Low cost surface door loop 400mm length	30 x 30 x 18
ALP135	Armoured door loop 400mm length	48 x 10 x 22
ALP135/L	Armoured door loop 560mm length	48 x 10 x 22

KEY SWITCH

Securefast key switches are available with maintained or momentary contacts with the option to add your own single euro profile cylinder.

For full details please refer to Datasheet.



Product Code	Description	Dimensions (mm)
AEBKS	Flush stainless steel maintained switch	88 x 88
FATE660-1	Flush stainless steel momentary switch	88 x 88
FATE668	Flush stainless steel momentary euro profile cylinder switch	88 x 88
FATE669	Flush stainless steel maintained euro profile cylinder switch	88 x 88

ACCESS CONTROL ACCESSORIES

Deedlock POWER SUPPLY

A range of 12V DC and 24V DC power supplies for use in access control, door entry and general fire and security applications.

- Switch mode units
- Meet essential European Directives
Low Voltage 2006/95/EC
EMC 2004/108/EC
WEEE 2002/96/EC
RoHS 2002/95/EC
- High efficiency electronics give reduced running costs and low operating temperature
- Installer safe with fully shrouded high voltage electronics
- Full electronic short circuit and overload protection
- Mains transient protection
- Lid open and tamper detection

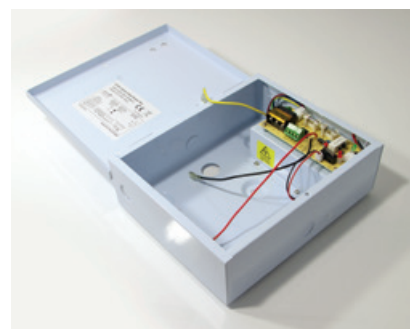

For full details please refer to Datasheet.

Product Code	Description	Voltage	Dimensions (mm)
ADP121A	Power supply unit - 1A	12V DC	200 x 240 x 75
ADP122A	Power supply unit - 2A	12V DC	200 x 240 x 75
ADP123A	Power supply unit - 3A	12V DC	200 x 240 x 75
ADP125A	Power supply unit - 5A	12V DC	360 x 330 x 90

Product Code	Description	Voltage	Dimensions (mm)
ADP241A	Power supply unit - 1A	24V DC	360 x 330 x 90
ADP24A	Power supply unit - 2A	24V DC	360 x 330 x 90
ADP243A	Power supply unit - 3A	24V DC	360 x 330 x 90
ADP245A	Power supply unit - 5A	24V DC	360 x 330 x 90
ADP2410A	Power supply unit - 10A	24V DC	360 x 330 x 90

Product Code	Description	Voltage	Dimensions (mm)
ADP241-TR	24V DC 1A boxed transformer rectifier	24V DC	200 x 240 x 75
ADP242-TR	24V DC 2A boxed transformer rectifier	24V DC	200 x 240 x 75
ADP244-TR	24V DC 4A boxed transformer rectifier	24V DC	200 x 240 x 75

DATASHEETS

DS3-002

DS3-003

DS3-004



WiFi HOME SECURITY

Being secure in one's home or place of work is a fundamental right that every one of us should be entitled to. The Securefast range of home security products are designed specifically to provide that reassurance and allows you to:

- Check your home, office or other property, inside and out at any time and from anywhere in the world on your smart phone
- Get alerts direct to your smart phone to check for unauthorised access or to monitor movement within internal or external spaces on your property
- Have 2 Way audio communication via your smartphone
- Check deliveries to your door or check on an elderly or vulnerable relative in their home, or just to check the kids have got back from school
- Record activity for up to 12 days
- Integrated solution with internal and external cameras, door bell and chime

WiFi HOME SECURITY

WiFi HOME SECURITY KIT

Our integrated array of video doorbell, internal and external cameras can be used in combination and accessed using the same APP on your smart phone or tablet.



AB72-2



AC10S



AML2C



AMLC1



APP ICsee

iOS & Android

- Easy to install
- Capture HD video footage
- Doorbell with large capacity battery
- 2 way audio communication
- Micro SD Card storage slot (32GB)
- AML2C Waterproof IP53 rated

Product Code	Description
AML2C	Video door bell complete with indoor chime AMLC1
AC10S	Portable WiFi camera with night vision
AB72-2	External camera with 2 way audio communication
ICSee	Mobile App (for iOS and Android) - Available to download
Please see overleaf for individual component information	

VIDEO DOORBELL WITH CHIME

See who is calling at your entrance door and communicate with them from anywhere in the world via your smart phone or tablet.

- One year stand by battery life needs no hard wiring
- Advanced high definition video and 2 way audio
- Long distance signal transmission supports smart phone real-time monitoring
- Built-in IR lighting for night vision
- Micro SD card and Cloud storage
- Micro USB cable required for charging



AMLC1
Indoor Chime

For full details please refer to Datasheet.

Product Code	Description	Dimensions
AML2C	Video door bell complete with indoor chime AMLC1	144 x 75 32mm
AMLC1	Additional indoor chime may be added	
ICSee	Mobile App (for iOS and Android) - Available to download	

VIDEO DOORBELL WITH CHIME

High grade IP53 waterproof and dustproof video doorbell with 2 way audio and plugable indoor chime.

- Six month stand by battery life needs no hard wiring but with optional 12-24V AC power source
- Advanced high speed video processor
- Long distance signal transmission supports smart phone real-time monitoring
- Built-in IR lighting for night vision
- Automatic recording with 2 way communication
- Micro SD card and Cloud storage



AMLC1
Indoor Chime

For full details please refer to Datasheet.

Product Code	Description	Dimensions
AML5C	IP53 Video door bell complete with indoor chime AMLC1	135 x 70 30mm
AMLC1	Additional indoor chime may be added	
XSHcam	Mobile App (for iOS and Android) - Available to download	

WiFi HOME SECURITY

WiFi CAMERAS

We have a range of indoor and outdoor cameras which can be used independently using a downloadable APP (for iOS or Android) or combined with a Video Doorbell to provide an integrated home security system.



Feature	AB72-2	AC10S-10	APT080-20	AC080-20	AC010-20
Internal/External	External	Internal	Internal	Internal	Internal or External
Dimensions	245 x 185 x 120mm	115 x 60 x 80mm	100 x 60mm	164 x 40 x 42mm	100 x 70 x 110mm
Camera Angle	65 Deg.	Wide Angle	350 Deg. Pan 110 Deg. Tilt	130 Deg.	85 Deg.
Resolution	1080p Full HD	720p	1080p Full HD	1080p Full HD	1080p Full HD
2 Way Audio	✓	✓	✓	✓	✓
Night Vision	✓	✓	✓	✓	✓
Recording	Record & Playback via 128GB Micro SD & Cloud storage	Remote image capture and network video playback	PAL, NTSC video system with YCC365 smart cloud technology 25FPS real time transmission	Record to 128GB Micro SD card or straight to smart phone	Record to 64GB Micro SD card or to Cloud storage
Features & Functions	IP67 for external use Aluminium construction Sharp night vision with 18 IR LEDs Supports 2.4GHz wireless networks 2MP camera 240V	Portable camera with magnetic base Wall monitoring bracket included Motion detector 1MP camera Supports 64GB Micro SD	Auto tracking motion detection Echo elimination and noise reduction Dual duplex audio effect Supplied with micro USB connector and plug in power adapter	Simple plug and play just connect to 2.4G WiFi Builtin PIR movement detection Battery powered, needing short charge every 6 months 6 built in LEDs giving 10m night vision	IP66 for external use Rechargeable battery PIR motion detector 2MP camera 64GB Micro SD will loop record for up to 12 days
APP	ICSee	ICSee	YCC365	ICSee	ICSee

DS17-003

DS17-002

DS17-004

DS17-006

DS17-007

PULSAR AUDIO DOOR ENTRY

The Pulsar audio entry system provides a cost effective door entry solution for single or dual occupancy buildings.

- Aluminium fascia design prevents water ingress into the speaker
- High visibility large blue backlit call button
- Slimline surface mount
- Attractive stylish Ellisse handset
- Available with 1 or 2 call buttons
- Address window
- 5 wire connection



For full details please refer to our Door Entry catalogue

Product Code	Description
F65021N	1 button entry panel for single entry c/w transformer and 1 handset
F65022N	2 button entry panel c/w transformer and 2 handsets

EASY KIT AUDIO DOOR ENTRY

The Easy Kit provides a comprehensive series of door entry solutions from 1 to 10 button, surface or flush mounted in 5 wire or 2 wire connection options.

- Aluminium fascia design prevents water ingress into the speaker
- Robust construction
- From 1 to 10 call button options
- Surface or flush mounted options
- Supplied with Ellisse handsets
- 5 wire or 2 wire connection options
- Flush mounted or with surface mount box (use suffix /SB)



For full details please refer to our Door Entry catalogue

Product Code	Description	Dimensions
F66261/SB	1 call button surface mounted audio entry kit c/w transformer and 1 Ellisse handset	155 x 115mm
F66262/SB	2 call button surface mounted audio entry kit c/w transformer and 2 Ellisse handsets	155 x 115mm
F66263/SB	3 call button surface mounted audio entry kit c/w transformer and 3 Ellisse handsets	205 x 115mm
F66264/SB	4 call button surface mounted audio entry kit c/w transformer and 4 Ellisse handsets	210 x 115mm
F66265/SB	5 call button surface mounted audio entry kit c/w transformer and 5 Ellisse handsets	255 x 115mm
For surface mounted audio entry kits please add /SB to product code (e.g. F6625/SB)		

TERMINOLOGY

AC (Alternating Current) - Term which refers to the voltage from a transformer or mains supply.

Amp - Measurement for the flow rate of electrical current (smaller amounts below 1 amp are quoted in milliamps (mA)).

ANSI - American National Standards Institute. Ensures mortice electric release dimensions for faceplate and side lip are the same for every version.

Anti Tamper screw - Screw which has a non-standard head (Hex or Torx drive head).

Armature Plate - Metal plate supplied with an electromagnetic lock and bolted to the door or bracket. Must be flexible when fixed to the door.

Back EMF - Electrical surge which is produced from the coil of an electric release or electromagnetic lock. Can cause an access control system to crash.

Backlit Buttons - Keypad buttons with lighting behind them to improve visibility in dark areas

Battery Backup - Rechargeable battery which fits into a DC Power Supply (PSU) to provide power for a limited period in a power Failure.

Break Glass / Call Point - Means of emergency release for a Fail-Safe locking device. Has a switch inside which is operated when glass panel is broken when pushed.

Current Draw - Amount of electrical current required to operate an electronic locking device. Usually measured in Amps or Milliamps.

Diode - Small electronic component used to protect an electronic device from Back EMF surges. Allows current to flow in one direction.

DC (Direct Current) - Term which refers to the voltage from a power supply unit (PSU).

DDA - Disability Discrimination Act. Effectively replaced by The Equality Act 2010 to incorporate the rights of all minorities.

Door Loop - Flexible metal tube used to transfer cable securely from the frame of a door to the door leaf of a pair of doors with an electric strike fitted.

Double Pole - Term used for switches or break glass call points. Means that the switch has 2 isolated sets of contacts (see also Single Pole).

Dual Voltage - Can be set to work on 2 different voltages (i.e.: 12 or 24)

Exit Button - Electrical spring switch which is used to momentarily control the electrical current to an electric locking device. Can be used with other devices.

Face to Face - Refers to the locking position of the armature plate against the face of an electromagnetic lock when fixing to a door.

Fail Locked / Fail Secure - Means an electric locking device will remain locked in a power failure.

Fail Unlocked / Fail Safe - Means an electric locking device will be unlocked in a power failure.

Fob - Plastic proximity device which works exactly the same as a proximity card but is more robust and can be attached to a key ring or chain.

Hall Effect Monitoring - Relay circuit which indicates correct alignment of the Armature plate on an electromagnetic lock.

Holding Force - Amount of pressure which can be applied to an electric locking device before it will release/unlock.

Interlock - Access control feature which allows at least 2 doors to be controlled by preventing 1 door from unlocking while the other door is open.

Jaw Strength - Amount of side pressure which can be applied to an electric strike's jaw before it will release/unlock.

Key Switch - Key operated switch used to override an electric locking device.

L Bracket - Bracket used to fix an electromagnetic lock on door frames with a shallow frame depth on outward opening doors.

Maintained - Term used for switches - means the switch will remain in either the On or Off position when operated.

Master Card/Fob - Card or fob which is used to put a card reader into the programming mode.

Master Code - Code number which is used to put a keypad or controller into the programming mode.

Momentary - Term used for switches - means the switch will change from On to Off only while the switch is pressed/turned.

Monitored - Shows the status of an electric locking device by signalling to an access control system that the device is locked or unlocked.

Mortice Mount - Refers to an electric lock which is fitted flush into a door or frame.

Networked - Group of access controllers which are linked together so that data can be shared between each controller and the PC

PSU (Power Supply) - Unit which is connected to a mains fused spur. Reduces 240v AC to 12v or 24v AC and then converts current to DC.

Proximity Card - Electronic card which is used with proximity readers. The card details are programmed onto a microchip attached to a coil of copper wire which acts as an aerial to pick up the radio signal from the proximity reader.

Proximity Reader - Access control reader which transmits a radio signal that reads the card or fob information when it is held in front of the reader.

Read Range - Distance that a card or fob can be held in front of a proximity reader before it can be recognised.

Relay - Electronic device which is used to switch voltage to an electric locking device. Can also be built into the circuit of an access control device.

Relay Rating - Maximum voltage, current and load in amps that can be switched through the relay contacts.

Relay Time - This is the number of seconds the relay will operate for. Zero seconds will toggle the relay On/Off.

Rim Mount - Refers to an electric release which is fitted to the face of the door frame.

Self Contained - Term used for access control keypad or card reader which means the unit has all the electronic controls built-in.

Single Pole - Term used for switches or break glass call points. The switch has a single set of isolated contacts (see Double Pole).

Solenoid - Electronic device which is fitted inside an electric release or bolt which controls the movement of the locking mechanism.

Stand Alone - Terms used for access control which means the unit works independently from other units in a building.

Transformer - Unit which is connected to a mains fused spur. Reduces 240v AC to 12v or 24v AC.

Test Key - Plastic key used to test the operation of a break glass or call point.

User Code - Code number which a person enters into a keypad to gain entry.

Voltage - Measurement of the energy available to drive the flow of electrical current.

Volt-Free Relay - Relay has not output voltage as standard (this requires the installer to fit a link wire from either Positive or Negative of power input).

Z&L Bracket - Set of 3 brackets used to fix an electromagnetic lock to the door & frame on an inward opening door.

Securefast 2020

Head Office

6 The Cedars Business Centre, Cannock, Staffordshire, WS11 1QJ

Tel: +44 (0) 1543 501600 Fax: +44 (0) 1543 501601

Email: sales@securefast.co.uk

Sales Office

First Floor, 14-16 Hoghton Street, Southport, Merseyside PR9 0PA

Tel: +44 (0) 1704 502801 Fax: +44 (0) 1704 502810

Email: sales@securefast.co.uk

Securefast Security Products Ltd (Ireland)

Unit A1, Ballymount Corporate Park, Ballymount Avenue, Dublin 12

Tel: +353 (0) 1456 8257

Web: www.securefast.ie

Technical Helplines

Mechanical Products: Tel: +44 (0) 1543 501611

Electronic and Fire Products: Tel: +44 (0) 1704 502815

Securefast IET: Tel: +44 (0) 1923 264425

Or by email: techsupport@securefast.co.uk

www.securefast.co.uk