

## Overview

### Junction Box View

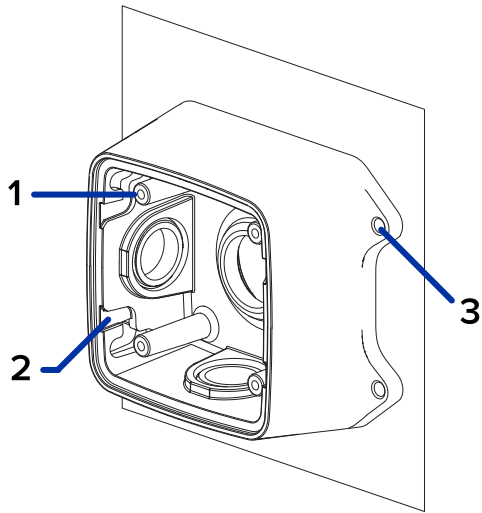

**1. Camera mounts**

Points for installing the camera to the junction box.

**2. Mounting hook slots**

Points to hold the camera to the junction box while connecting the required cables.

**3. Mounting holes**

Holes for securing the junction box to the mounting surface.

### Front View

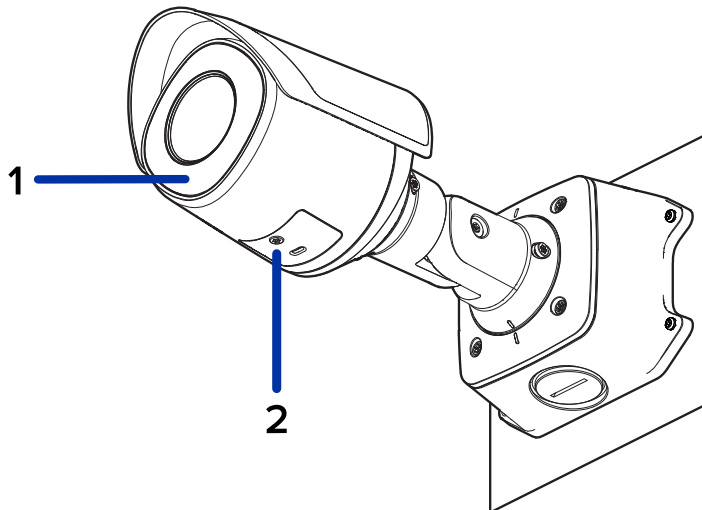

**1. IR Illuminator**

Provides scene illumination in the IR spectrum.

**2. Configuration panel cover**

Covers the configuration panel.

## Side View

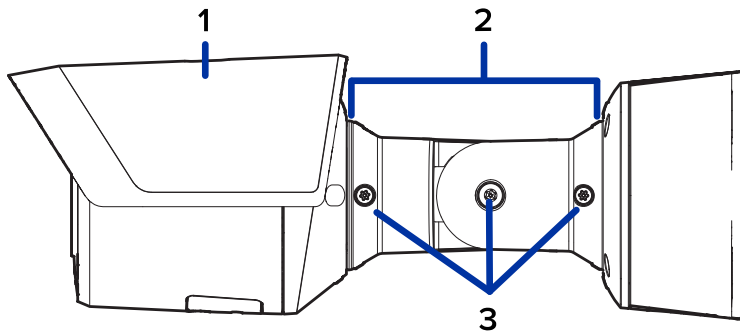

- 1. Sun shroud**  
An adjustable cover to help protect the lens against glare from the sun.
- 2. Mount arm**  
Adjustable mount arm for positioning the camera.
- 3. Adjustment screws**  
Provides a locking mechanism for the mount arm.

## Rear View

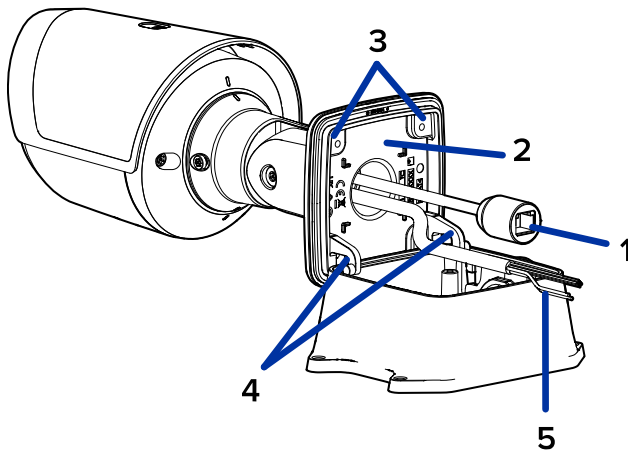

- 1. Ethernet port**  
Accepts power and Ethernet connection to the network. Server communication and image data transmission also occur over this connection.  
The camera can either be powered by Power over Ethernet (PoE) or 12 VDC Aux.
- 2. Serial number tag**  
Device information, product serial number and part number label.
- 3. Camera mounting screws**  
Screws for mounting the camera to the junction box.
- 4. Mounting hooks**  
Hooks to attach the camera to the junction box while connecting the required cables.
- 5. Power and I/O cables**  
Cables for connecting the camera to auxiliary power and I/O devices. For more information, see [Connecting to External Devices](#).

## Configuration Panel View

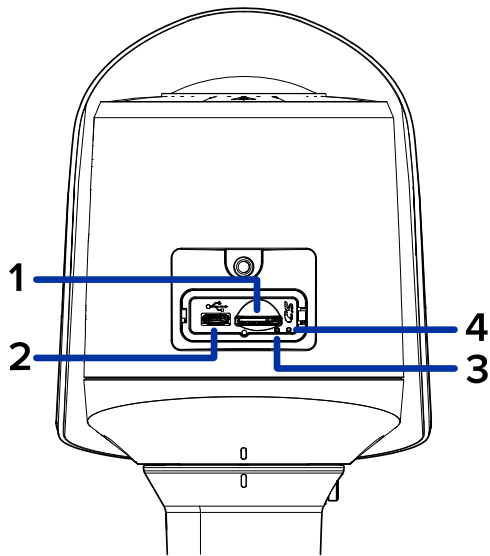

**1. microSD card slot**

Accepts a microSD card for onboard storage. For more information, see [\(Optional\) Configuring microSD Card Storage](#).

**2. Micro USB port**

Accepts a micro USB to USB adapter. Only required when using the USB Wi-Fi Adapter.

**3. Link LED indicator**

Amber LED indicates if there is an active connection in the Ethernet port.

**4. Connection status LED indicator**

Green LED provides information about device operation. For more information, see [Connection Status LED Indicator](#).