

# KEY-EP Proximity Reader

## Installation Instructions

The KEY-EP is an external proximity tag reader designed to work with keypads such as the KEY-KPZ01, KEY-KP01 and KEY-FKPZ.

The KEY-EP can be used to set or unset the system from outside the protected area. Depending on configuration, you may need to start the setting procedure inside the protected area using a keypad.

Please note that the control unit requires firmware version 4.03 or later.

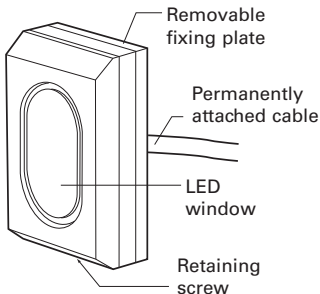

### Installing the reader

#### Step 1: Choose a mounting location

- Locate the reader at a convenient position and height for users.
- Do not locate the reader next to computers, photocopiers, radio equipment, CAT 5 data lines or industrial mains equipment.

- Make sure the reader is not closer than 1 metre to another proximity reader (including a proximity reader located within a keypad). If you do, the readers may be unable to read tags.

#### Step 2: Install the wiring

The KEY-EP is fitted with a 2m length of cable. You can extend the cable up to 50m by connecting an additional length of 7/0.2 un-screened alarm cable.

# EATON

*Powering Business Worldwide*

**Note:** Keep the reader cable separate from any other wiring such as mains supply cables, telephone cables, computer network cables, R.F. cables, and cables supplying sounders or extension loudspeakers.

### Step 3: Open the reader

Open the reader as shown in Figure 1.

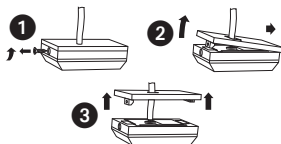

Figure 1. Opening the reader

### Step 4: Fit the backplate

See Figure 2. Use M4 25mm countersunk screws, with a thread suitable for the wall material, at both fixing holes. Ensure that the retaining screw will be at the bottom of the unit.

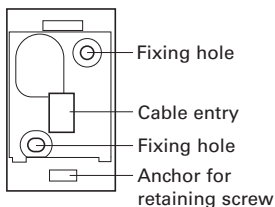

Figure 2. Reader backplate

### Step 5: Connect the reader to the keypad

Figure 3 shows the wiring connections to the keypad. Do not connect the yellow wire.

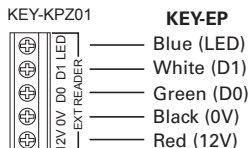

Figure 3. Connection details

### Step 6: Enable the reader

Use the following options within the control unit's Installer menu to enable the reader:

- **Detectors/Devices, Wired Keypads, Edit Keypad, <keypad name>, External Prox** —

To enable the external proximity reader at the selected keypad.

- **System Options, User Access, Terminated Set** —

**Note:** This option is available if the control unit has firmware version 4.05 or later. If this option is not available, configure the system as if Terminated Set were set to Y, as described next.

Set Terminated Set to Y (the default) if you want to start the setting procedure

from a keypad and complete the setting procedure from the KEY-EP. If you use this setting, also configure the exit mode to Exit Terminate using *Partitions/Wards* (for a partitioned/warded system) or *Setting Options* (for a part-setting system).

When Terminated Set is to Y, will not be able to start the setting procedure from the KEY-EP.

If you select N for Terminated set, you will be able to set the system from the KEY-EP (or from a keypad); there is no requirement to use a keypad first. In this case, choose an exit mode such as Timed Set or Instant Set. When you present the proximity tag to the KEY-EP, the system sets with no further action.

For both settings of Terminated Set, presenting a tag to the KEY-EP when the system is set immediately unsets the system.

## Using the KEY-EP

To set and unset the system:

1. If Terminated Set is set to Y (see the previous section), present your proximity tag to the keypad or enter your access code.
2. Present your proximity tag to the KEY-EP. The system sets.
3. When entering the premises, present your proximity tag to the KEY-EP and the system unsets immediately.

## About the reader LED

The KEY-EP has a built-in LED, which can glow for 10 seconds to indicate that the system has set. This LED mimics the action of the LED under the "A" key on the keypad as follows:

- In a part-setting system, the LED glows for 10 seconds when the system is full set.
- In a partitioned/warded system, the LED glows for 10 seconds when partition/ward 1 is full set.

The jumpers in the keypad do not control the function of the LED.

# Specifications

**Panel software:** 4.03 or later.

**Case Material:** Polycarbonate.

**Intrusion Standards:** PD6662:2010, EN50131-3:2009.

**EN50131-3 Grade:** Grade 3.

**EU Compliance Standards:**  
R&TTE: 1999/5/EC, EMC: 2004/108/EC, RoHS: 2011/65/EC, WEEE: 2012/19/EC, EUP: 2005/32/EC, Low voltage: 2006/95/EC, General safety: 2001/95/EC.

**Weight:** 95g (including 2m cable)

**Operating Temp. Range:** -25°C to +60°C

**Max Relative Humidity:** 95%

**Environmental Class:** Class IV

**Dimensions:** 58 mm (h) x 34 mm (w) x 19 mm (d)

This product must be installed by qualified service personnel.

The information, recommendations, descriptions and safety notations in this document are based on Eaton Corporation's ("Eaton") experience and judgment and may not cover all contingencies. If further information is required, an Eaton sales office should be consulted. Sale of the product shown in this literature is subject to the terms and conditions outlined in appropriate Eaton selling policies or other contractual agreement between Eaton and the purchaser.

THERE ARE NO UNDERSTANDINGS, AGREEMENTS, WARRANTIES, EXPRESSED OR IMPLIED, INCLUDING WARRANTIES OF FITNESS FOR A PARTICULAR PURPOSE OR MERCHANTABILITY, OTHER THAN THOSE SPECIFICALLY SET OUT IN ANY EXISTING CONTRACT BETWEEN THE PARTIES. ANY SUCH CONTRACT STATES THE ENTIRE OBLIGATION OF EATON. THE CONTENTS OF THIS DOCUMENT SHALL NOT BECOME PART OF OR MODIFY ANY CONTRACT BETWEEN THE PARTIES.

In no event will Eaton be responsible to the purchaser or user in contract, in tort (including negligence), strict liability or otherwise for any special, indirect, incidental or consequential damage or loss whatsoever, including but not limited to damage or loss of use of equipment, plant or power system, cost of capital, loss of power, additional expenses in the use of existing power facilities, or claims against the purchaser or user by its customers resulting from the use of the information, recommendations and descriptions contained herein. The information contained in this manual is subject to change without notice.

© 2016 Eaton  
Eaton, Security House,  
Vantage Point Business Village,  
Mitcheldean, GL17 0SZ.  
[www.touchpoint-online.com](http://www.touchpoint-online.com)

Product Support (UK) Tel: +44 (0) 1594 541978 available 08:30 to 17:00 Monday to Friday.  
email: [securitytechsupport@eaton.com](mailto:securitytechsupport@eaton.com)

Part number 12656280 Issue 3,  
04/04/16

