

7100 Electric Strikes

Electric Strike - 7113

The Adams Rite 7100 Series is for remote use access control of any door equipped with Adams Rite 4700 series (or similar) deadlatch

The 7113 is suitable for single or double leaf timber or steel doors



Key Benefits

- Square corners to the faceplate makes it suitable for use on timber and steel doors
- Non-handed
- Facility to change duty from fail-safe to fail secure and vice versa
- The 7113 features a narrower faceplate than the 7110 series and is particularly suited to 44mm thick timber doors
- Electrical actuation unlocks the strike jaw, releasing the latchbolt so the door can be opened without operating the latch itself
- 907kg holding force (2000lbs)
- Guarantee 3 years

Related Hardware

RiteKey Keypad ~ Push-to-Exit Button ~ Power Supply Unit ~ 4720ANSI Deadlatch

7100 Electric Strikes

Electric Strike - 7113

Specification

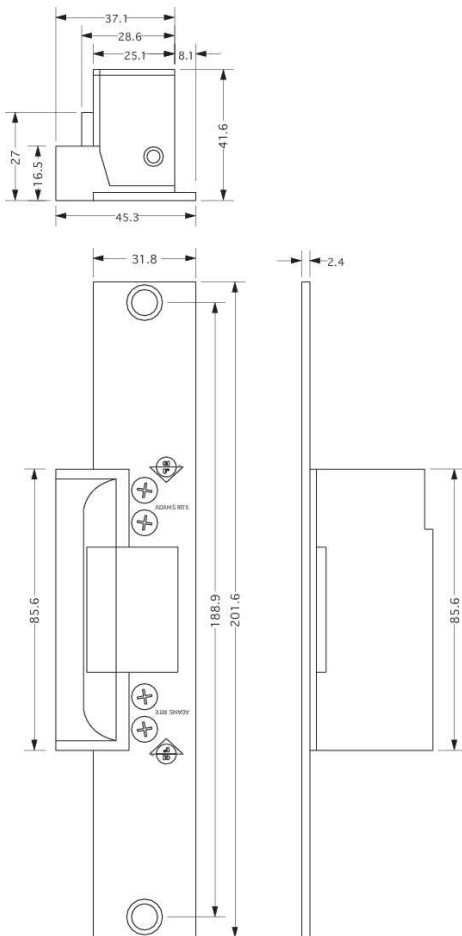

Subcover Extension Codes/ Sizes

Code	Dimension *	Code	Dimension*
-01	38.1mm (1.50")	-08	60.5mm (2.38")
-02	41.4mm (1.63")	-09	63.5mm (2.50")
-03	44.5mm (1.75")	-10	66.8mm (2.63")
-04	47.8mm (1.88")	-11	69.9mm (2.75")
-05	50.8mm (2.00")	-12	73.2mm (2.88")
-06	54.1mm (2.13")	-13	76.2mm (3.00")
-07	57.2mm (2.25")		

*Dimension from door centreline to jamb edge.

Current Draw:	12vAC=1.48A, 12vDC=0.332A, 24vAC=0.74A, 24vDC=0.19A (nominal). DC intermittent and continuous units are silent, AC intermittent units "buzz" on operation.
Voltage Tolerance:	+/- 10%
Powered by:	Internal solenoid
Monitoring:	(Optional) Single: Latch only, Double: Latch & solenoid.
Duty:	Fail-safe or fail-secure (convertible without additional parts). DC power supply required for fail-safe operation.
Jaw Strength:	907kg (2000lbs).
Case:	85.6mm x 28.6mm x 41.6mm. Zinc aluminium alloy.
Mechanism:	Stainless steel internal blocking mechanism.
Strike Opening:	36.5mm x 15.9mm x 12.7mm. Stainless steel bolt retainer jaw.
Door gap:	Minimum 3mm, operational gap 3-5mm
Faceplate:	Steel. 201.6mm x 31.8mm. Flat, square cornered.
Finishes:	Satin chrome (other finishes may be available on request).
Subcover:	Basic subcover lip will suit a 44.45mm (1 3/4") thick door that closes flush with jamb edge. For extended bolt-on subcovers see ordering codes.
Standards:	ANSI/BHMA 156.5 Grade 1. UL Listed for burglary resistance.

Ordering Information

7113-310-652	7113 12VDC FAIL SECURE ELECTRIC RELEASE SC
7113-315-652	7113 12VDC FAIL SAFE ELECTRIC RELEASE SC
7113-317-652-1	7113 12VDC FAIL SAFE ELECTRIC RELEASE SC SINGLE MON
7113-319-652-1	7113 12VDC FAIL SECURE ELECTRIC RELEASE SC SINGLE MON
7113-340-652	7113 12VAC FAIL SECURE ELECTRIC RELEASE SC
7113-515-652	7113 24VDC FAIL SAFE ELECTRIC STRIKE SC

Subcover Extensions

91-0171-01	01 SUBCOVER EXTENSION 7100 & 7140
91-0171-02	02 SUBCOVER EXTENSION 7100 & 7140
91-0171-03	03 SUBCOVER EXTENSION 7100 & 7140
91-0171-04	04 SUBCOVER EXTENSION 7100 & 7140
91-0171-05	05 SUBCOVER EXTENSION 7100 & 7140
91-0171-06	06 SUBCOVER EXTENSION 7100 & 7140
91-0171-07	07 SUBCOVER EXTENSION 7100 & 7140
91-0171-08	08 SUBCOVER EXTENSION 7100 & 7140
91-0171-09	09 SUBCOVER EXTENSION 7100 & 7140
91-0171-10	10 SUBCOVER EXTENSION 7100 & 7140
91-0171-11	11 SUB-COVER EXTENSION 7100 & 7140
91-0171-12	12 SUB-COVER EXTENSION 7100 & 7140
91-0171-13	13 SUBCOVER EXTENSION 7100 & 7140
91-0174-05	05 SUBCOVER EXTENSION 7130
91-0174-07	07 SUBCOVER EXTENSION 7130

Accessories

31-0044-03	12VAC SOLENOID FAIL SECURE
31-0044-05	12VDC 24VAC SOLENOID FAIL SAFE/SEC
31-0044-07	24VDC SOLENOID FAIL SAFE/SECURE
91-0077-01-603	7100 ELECTRIC STRIKE FIXING PACK